



# User Guide

Sound Bar

# SR-C30A

EN

# CONTENTS

## INTRODUCTION 5

---

<b>About this User Guide</b> .....	<b>5</b>
<b>Features</b> .....	<b>6</b>
<b>Confirming the included items</b> .....	<b>8</b>

## PART NAMES AND FUNCTIONS 10

---

<b>Part names of the sound bar (front/top)</b> .....	<b>10</b>
<b>Part names of the sound bar (rear)</b> .....	<b>12</b>
<b>Part names of the subwoofer</b> .....	<b>13</b>
<b>Part names of the remote control</b> .....	<b>14</b>

## PREPARATION 16

---

<b>Preparation</b> .....	<b>16</b>
<b>Precautions for preparation</b> .....	<b>18</b>
<b>Installing the product</b> .....	<b>20</b>
<b>Connecting a TV</b> .....	<b>22</b>
Connecting a TV to the sound bar .....	22
Connecting a TV using only the included digital optical audio cable .....	24
Connecting a TV using an HDMI cable (commercially available) .....	26
<b>Connecting an audio device</b> .....	<b>30</b>
<b>Preparing the remote control</b> .....	<b>34</b>
<b>Turning on and off the sound bar</b> .....	<b>35</b>

## PLAYBACK 36

---

<b>Basic control during playback</b> .....	<b>36</b>
--	-----------

<b>Adjusting the sound to your preference</b> .....	<b>38</b>
Sound functions of this product .....	38
Surround playback .....	40
Stereo playback .....	41
Adjusting the volume of the subwoofer .....	42
Playing back human voices clearly (CLEAR VOICE) .....	43
Enjoying rich bass sound (BASS EXT) .....	44
<b>Listening to audio from a Bluetooth® device</b> .....	<b>45</b>

## **ADDITIONAL FEATURES 48**

---

<b>Changing the brightness of the indicators (Dimmer)</b> .....	<b>48</b>
<b>Using a TV’s remote control to control the sound bar (HDMI Control)</b> .....	<b>49</b>
<b>Showing the type of audio signal and settings for functions</b> .....	<b>50</b>
<b>Controlling the sound bar with the smartphone app</b> .....	<b>51</b>

## **CONFIGURATION 52**

---

<b>Enabling/disabling the HDMI Control function</b> .....	<b>52</b>
<b>Enabling/disabling the Auto Power Standby function</b> .....	<b>53</b>
<b>Enabling/disabling the Child Lock function</b> .....	<b>54</b>
<b>Enabling/disabling the Bluetooth Standby function</b> .....	<b>55</b>
<b>Enabling/disabling the Bluetooth function</b> .....	<b>56</b>
<b>Setting the dynamic range compression level</b> .....	<b>57</b>
<b>Setting the frequency characteristics of the sound according to how the sound bar is installed</b> .....	<b>59</b>
<b>Initializing the sound bar</b> .....	<b>61</b>

## **TROUBLESHOOTING 62**

---

<b>Check the following first when any problem occurs</b> .....	<b>62</b>
<b>When a problem occurs: Power or overall functionality</b> .....	<b>63</b>
<b>When a problem occurs: Audio</b> .....	<b>71</b>
<b>When a problem occurs: Bluetooth®</b> .....	<b>76</b>
<b>When a problem occurs: App</b> .....	<b>78</b>

**Other actions ..... 79**

- How to connect AV devices such as BD/DVD players ..... 79
- How to minimize standby power consumption ..... 80
- Precautions for remote control batteries ..... 81
- How to replace the remote control battery ..... 82
- What to do if the sound bar and subwoofer are not paired automatically ..... 83
- How to reset the sound bar ..... 85

**APPENDIX ..... 86**

---

**Specifications ..... 86**

**Supported digital audio signal formats ..... 89**

**List of indicator displays ..... 90**

**About third party software programs ..... 94**

**List of support centers ..... 95**



# INTRODUCTION

## About this User Guide

- This User Guide uses the following signal words for important information:



### **WARNING**

This content indicates “risk of serious injury or death.”



### **CAUTION**

This content indicates “risk of injury.”

### **NOTICE**

Indicates points that you must observe in order to prevent product failure, damage or malfunction and data loss, as well as to protect the environment.

### **NOTE**

Indicates notes on instructions, restrictions on functions, and additional information that may be helpful.

- The illustrations and screens in this User Guide are for instructional purposes only.
- The company names and product names in this User Guide are the trademarks or registered trademarks of their respective companies.
- Various smartphones and tablet devices are collectively referred to as “mobile devices”. When necessary, the type of mobile device is specified in the explanations.
- A [Search tag] is a keyword for searching. This serves as a link from the Quick Start Guide to the User Guide.

### **NOTE**

The Safety Brochure and the Quick Start Guide are included with this product. See the Safety Brochure first.

## Features

This product is a bar-shaped speaker system for your TV that allows you to easily enjoy surround sound on the TV with a rich sense of presence.

### ■ Produce surround sound just by connecting to a TV



### Related links

“Surround playback” (p.40)

### ■ Easily play audio content from a Bluetooth device



### **Related links**

“Listening to audio from a Bluetooth® device” (p.45)

## ■ **Configure the sound to match the situation**

### **Clear Voice**

This function focuses on the acoustic image of human voices such as dialog and narration within the audio and emphasizes the voices without changing the overall volume or individuality of the sound. Only the human voices become easier to hear, and it gives a clear sense of localization to the human voices.

- “Playing back human voices clearly (CLEAR VOICE)” (p.43)

### **Bass Extension**

This function focuses on the acoustic image of the bass portion and enhances bass sound. It allows you to enjoy rich bass performance with a strong presence without disturbing the balance of the overall sound.

- “Enjoying rich bass sound (BASS EXT)” (p.44)

## ■ **Multiple control methods to suit various usage situations**

In addition to the sound bar’s controls and the included remote control, the TV’s remote control and the dedicated smartphone app “Sound Bar Remote” can also be used to control the sound bar.

### **Audio Return Channel (ARC) and HDMI Control function**

An HDMI control function compatible TV allows for controlling the sound bar’s basic functions using the TV’s remote control. An Audio Return Channel (ARC) compatible TV can be connected to the sound bar using a single HDMI cable.

- “Using a TV’s remote control to control the sound bar (HDMI Control)” (p.49)
- “Connecting a TV using an HDMI cable (commercially available)” (p.26)

### **Dedicated smartphone app: “Sound Bar Remote”**

The sound bar can also be controlled from your mobile device. The app allows you to check the current sound mode, sound settings, and volume level of the sound bar.

## ■ **Certified as a Yamaha Eco-Product**



Yamaha Eco-Label is a mark that certifies products of high environmental performance.

With an advanced energy saving design, this product achieves a low power consumption of 1.8 W or less when in standby mode.

## Confirming the included items

The following items are included with this product. Make sure that all of the included items are present.

### ■ Main devices

- Sound bar (SR-CUC30A)



- Subwoofer (SR-WSWC30A)



### ■ Accessories

- Remote control



\* A Lithium battery (CR2025) has already been inserted into the remote control.

- AC adaptor (model number: ANAD-420FIOT-B)

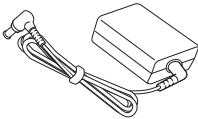

- Power cords (×2)



- Digital optical audio cable



INTRODUCTION > Confirming the included items

- Non-skid pads (×4 on 1 sheet)



\* Attach these to the bottom of the subwoofer.

- Mounting template



\* Use when mounting the sound bar on a wall.

- Spacers (A: ×2, B: ×2 on 1 sheet)



\* Use when mounting the sound bar on a wall.

- Quick Start Guide



- Safety Brochure



# PART NAMES AND FUNCTIONS

## Part names of the sound bar (front/top)

This section describes the part names and functions of the front/top of the sound bar.

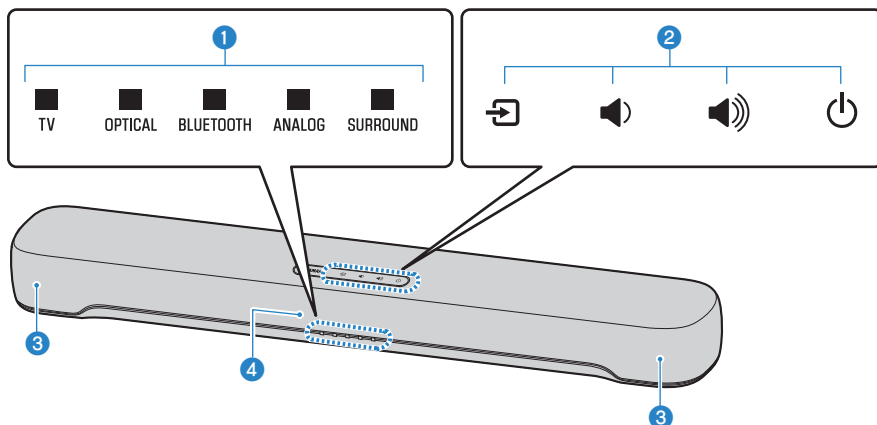

### 1 Indicators

The indicators flash or glow to show the operation and setting status. During normal playback, the setting status is indicated as follows:

TV, OPTICAL, BLUETOOTH, or ANALOG: Selected playback device

SURROUND: Surround playback (glowing) / Stereo playback (off)

#### NOTE

This document uses the following illustrations to show that indicators are off, glowing, or flashing.



Off



Glowing



Flashing

### 2 Controls

Touch the symbols with your fingertip to control the sound bar.

 (Input): Select an input source (p.36).

 /  (Volume +/-): Adjust the volume (p.36).

 (Power): Turn the sound bar on and off.

### 3 Speakers

### 4 Remote control sensors

**NOTE**

- To prevent unintended operation, do not place anything on the controls of the sound bar.  
Enabling the Child Lock function prevents accidental operation.
- The brightness of the indicators can be adjusted by pressing DIM.

**Related links**

- “Enabling/disabling the Child Lock function” (p.54)
- “Changing the brightness of the indicators (Dimmer)” (p.48)
- “List of indicator displays” (p.90)

## Part names of the sound bar (rear)

This section describes the part names and functions of the rear of the sound bar.

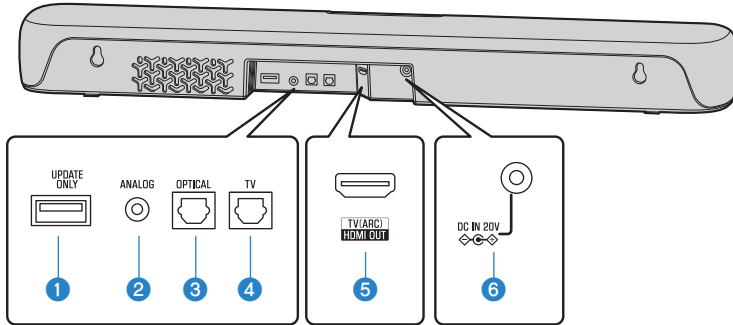

**1 UPDATE ONLY jack**

Use to update the sound bar's firmware.

Refer to the instructions supplied with the firmware for details.

**2 ANALOG input jack (p.30)**

**3 OPTICAL input jack (p.30)**

**4 TV input jack (p.22)**

**5 HDMI OUT/TV (ARC) jack (p.26)**

**6 DC IN (20V) jack**

### Related links

- "Part names of the sound bar (front/top)" (p.10)
- "Part names of the remote control" (p.14)



## Part names of the subwoofer

This section describes the part names and functions of the subwoofer.

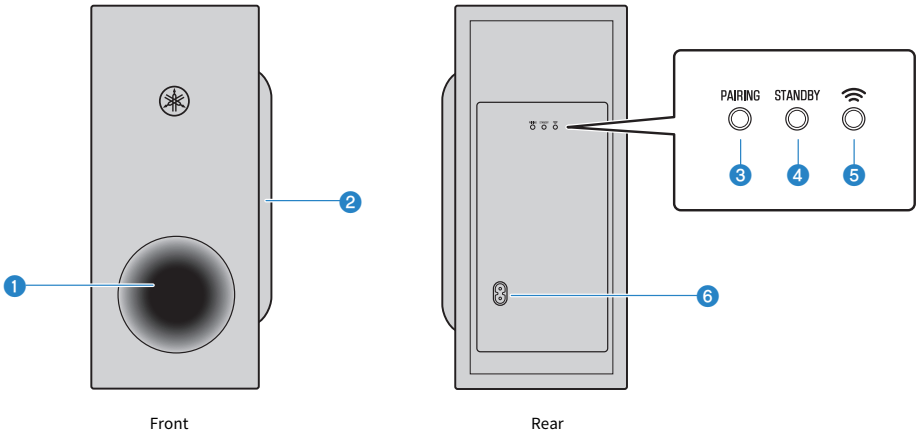

**1 Bass reflex port**

**2 Speaker**

**3 PAIRING button**

Use to pair the sound bar with the subwoofer manually. (p.83).

**4 STANDBY indicator**

Indicates the status of the subwoofer (p.72).

**5 Wi-Fi Indicator**

Glowes when the subwoofer is connected to the sound bar (p.35).

**6 AC power input connector**

Use to connect the power cord of the subwoofer.

### Related links

"List of indicator displays" (p.90)

## Part names of the remote control

This section describes the part names and functions of the remote control.

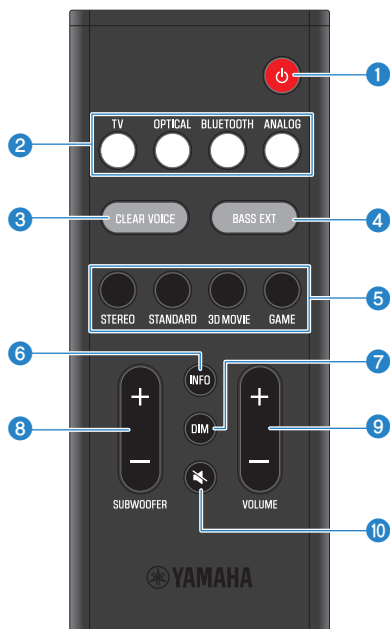

**1 (Power) button**

Turn the sound bar on and off (p.35).

**2 Input source buttons**

Select an audio input source (p.36).

- TV button: Audio from a TV
- OPTICAL button: Audio from a device connected to the OPTICAL input jack
- BLUETOOTH button: Audio from a Bluetooth device
- ANALOG button: Audio from a device connected to the ANALOG input jack

**3 CLEAR VOICE button**

Enable or disable the Clear Voice function (p.43).

**4 BASS EXT button**

Enable or disable the Bass Extension function (p.44).

**5 Sound mode buttons**

Switch to your preferred sound mode (p.38).

- STEREO
- STANDARD
- 3D MOVIE
- GAME

**6 INFO button**

Check information such as the type of audio signal being played and the settings for the sound bar's functions (p.50).

**7 DIM button**

Switch the brightness of the indicators of the sound bar (p.48).

**8 SUBWOOFER (+/-) button**

Adjust the volume of the subwoofer (p.42).

**9 VOLUME (+/-) button**

Adjust the volume of the sound bar (p.36).

**10  (Mute) button**

Mute the audio output (p.36). Press this button again, or press VOLUME (+/-) to unmute.

**NOTE**

Use the remote control within the range shown in the following illustration:

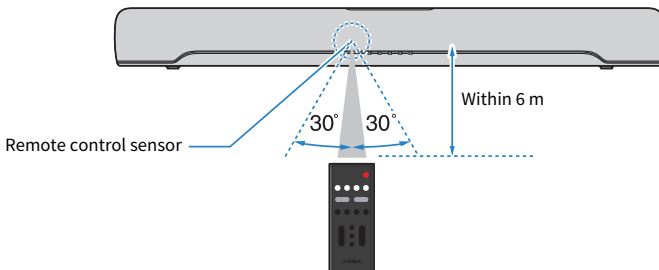

**Related links**

"Part names of the sound bar (front/top)" (p.10)

# PREPARATION

## Preparation

Install the sound bar and connect a TV to it.

### **1 Install the sound bar and subwoofer.**

“Installing the product” (p.20)

### **2 Connect a TV to the sound bar.**

Connect the TV to the sound bar using a method suitable for the type of jacks on the TV and the functions to be used.

“Connecting a TV using only the included digital optical audio cable” (p.24)

“Connecting a TV using an HDMI cable (commercially available)” (p.26)

### **3 Connect an audio device (if required).**

“Connecting an audio device” (p.30)

### **4 Prepare the remote control.**

“Preparing the remote control” (p.34)

### **5 Turn on the sound bar.**

When the sound bar is turned on, the subwoofer turns on at the same time.

“Turning on and off the sound bar” (p.35)

**NOTE**

- Connect AV devices (such as BD/DVD players and set top boxes) to the TV's HDMI input jacks.

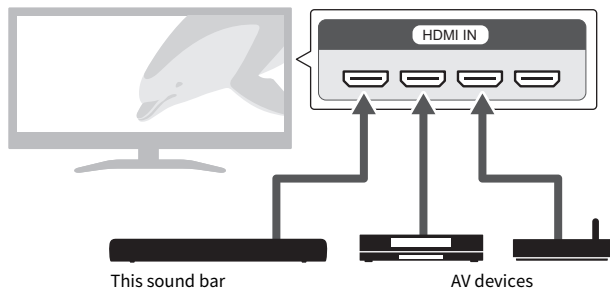

- When playing audio from a TV or AV device via the sound bar, set the input sources as follows:
  - Sound bar's input source: TV
  - TV's input source: AV device playing the content
- Audio Return Channel (ARC) is a function that transmits audio signals from the TV's HDMI input jack. This provides the same quality of audio as when connected with an digital optical audio cable.

## Precautions for preparation

Before installing the sound bar and connecting other devices, be sure to read the following precautions. Be sure to follow the precautions.

### ■ Precautions for installation



#### WARNING

- Install as instructed in the User Guide. Failure to observe this may cause devices to fall and result in injury.
- Confirm that the finished installation is safe and secure. Also, carry out safety inspections periodically. Failure to observe this may cause devices to fall and result in injury.
- Do not expose the product to rain, use it near water or in damp or wet conditions, or place on the product any containers (such as vases, bottles or glasses) containing liquids which might spill into any openings or places where water may drop. A liquid such as water getting into the product may cause a fire, electric shocks, or malfunctions.
- Do not place any burning items or open flames near the product, since they may cause a fire.
- Do not use this product near medical devices or inside medical facilities. Radio waves from this product may affect electro-medical devices.



#### CAUTION

- Do not place the product in an unstable position where it might accidentally drop or fall over and cause injuries.
- When installing this product, do not obstruct heat dissipation. Failure to observe this may trap heat inside the product, causing a fire or malfunctions.
- Avoid being near the product during a disaster, such as an earthquake. Since the product may turn over or fall and cause injury, quickly move away from the product and go to a safe place.

#### NOTICE

- Do not install the product in places where it may come into contact with corrosive gases or salt air, or places that have excessive smoke or steam. Doing so may result in malfunction.
- Do not press hard on the speaker units or fabric-covered portion of this product.
- Do not place any objects susceptible to magnetism (such as a hard disk drive or magnetic card) near the product. The magnetic effect of the sound bar may cause damage to the object or its recorded data.
- Do not use this product in a location that becomes extremely hot, such as in direct sunlight or near a heater, or that becomes extremely cold, or that is subject to excessive dust or vibration. Failure to observe this may cause this product's panel to become deformed, the internal components to malfunction, or for operation to become unstable.
- If using a wireless function, avoid installing this product near metal walls or desks, microwave ovens, or other wireless network devices. Obstructions could shorten the transmission distance.
- Do not stack the sound bar and subwoofer directly on top of one another. Also, do not stack other AV devices directly on or under this product. These devices may malfunction due to vibrations.
- Do not place the subwoofer in the following ways. Doing so may cause a loss in bass sound volume.
  - With the speaker units (fabric-covered portion) placed tightly against the wall
  - With the bass reflex port blocked
- Do not place furniture or other objects made of metal between the sound bar and subwoofer. Doing so may interfere with the wireless connection.

## ■ Precautions for connections



### **WARNING**

- Use this product with the power supply voltage printed on it. Failure to observe this may cause a fire, electric shocks, or malfunctions.
- Be sure to use the included power cord and AC adaptor. Do not use the included power cord and AC adaptor for other devices. Failure to observe this may cause a fire, electric shocks, or malfunctions.
- Never insert or remove an electric plug with wet hands. Do not handle this product with wet hands. Failure to observe this may cause electric shocks or malfunctions.
- Do not touch the power plug or cord if there is a chance of lightning. Failure to observe this may cause electric shocks.
- When setting up the product, make sure that the AC outlet you are using is easily accessible. If some trouble or malfunction occurs, immediately turn off the power switch and disconnect the plug from the AC outlet. Even when the power switch is turned off, as long as the power cord is not unplugged from the wall AC outlet, the product will not be disconnected from the power source.
- If not using the product for long periods of time, be sure to pull the power plug from the AC outlet. Failure to observe this may cause a fire or malfunctions.
- Check the electric plug periodically and remove any dirt or dust which may have accumulated on it. Failure to observe this may cause a fire or electric shocks.



### **CAUTION**

- Do not use an AC outlet where the power plug fits loosely when inserted. Failure to observe this may cause a fire, electric shocks, or burns.
- When disconnecting the power plug, always hold the plug itself and not the cord. Pulling by the cord can damage it and cause electric shocks or a fire.
- Insert the power plug firmly all the way into the AC outlet. Using the product when it is not plugged in sufficiently can cause dust to accumulate on the plug, causing a fire or burns.

### **NOTICE**

- If connecting external devices, be sure to thoroughly read the User Guide for each device and connect them in accordance with the instructions. Failure to properly handle a device in accordance with the instructions could cause malfunctions.
- Do not connect this product to industrial devices. This product has been designed to connect to consumer-use devices. Connection to an industrial-use device could cause this product to malfunction.

## Installing the product

- Before installing the sound bar, be sure to read the following precautions.
  - “Precautions for preparation” (p.18)

Install the sound bar as shown in the following illustration.

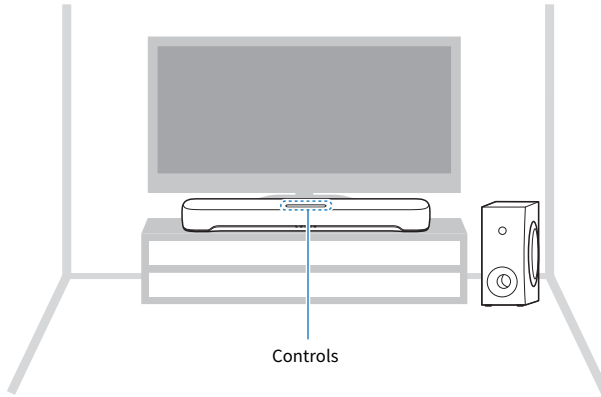

### ■ Installing the subwoofer

There are two ways to install the subwoofer: upright and on its side. Attach the non-skid pads to the bottom of the subwoofer according to how the subwoofer is installed.

#### Installing the subwoofer upright

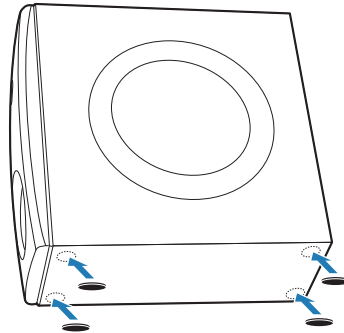



## Installing the subwoofer on its side

[Search tag] # Q01 Subwoofer horizontal

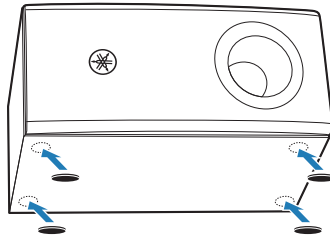

### NOTICE

- When installing the subwoofer on a rack, ensure the following amount of space so as not to interfere with heat dissipation and bass output.

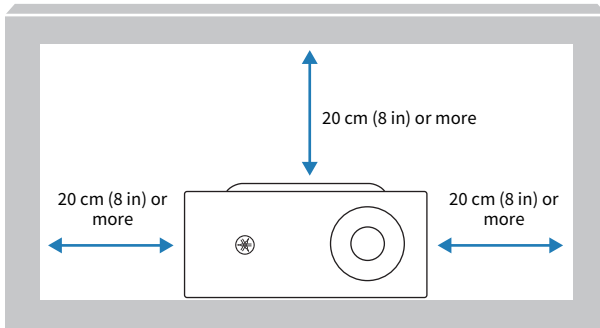

### NOTE

- For proper installation of the sound bar on a wall, make sure to have it done by the dealer from which you purchased the unit or by a qualified contractor. Refer to the Wall Mounting Installation Guide for more information.  
[https://manual.yamaha.com/av/sb/wallmount/src20a\\_c30a/](https://manual.yamaha.com/av/sb/wallmount/src20a_c30a/)
- If you change how the sound bar is installed, switch the frequency characteristics. This will make the sound suitable for whichever way the sound bar is installed (p.59).

### Related links

“Setting the frequency characteristics of the sound according to how the sound bar is installed” (p.59)

## Connecting a TV

### Connecting a TV to the sound bar

Select the connection procedure according to the type of jacks on the TV and the functions to be used.

#### ■ Connecting a TV equipped with a digital optical audio output jack, and controlling the sound bar using the remote control included with this product

Connect the TV using the included digital optical audio cable.

Cable: Digital optical audio cable (included)

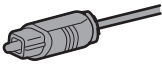

Jack of TV to connect to: Digital optical audio output jack



Connection procedure

“Connecting a TV using only the included digital optical audio cable” (p.24)

#### ■ Controlling the sound bar using the TV’s remote control

Connect a TV using an HDMI cable. Prepare a commercially available HDMI cable compatible with Audio Return Channel (ARC). When connecting to an HDMI input jack not compatible with ARC, also connect the included digital optical audio cable.

Audio Return Channel (ARC) is a function that transmits audio signals from the TV’s HDMI input jack. An ARC-compatible HDMI input jack is labeled as “ARC.”

Cable: HDMI cable (commercially available) and, if needed, digital optical audio cable (included)

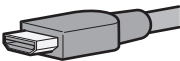

When connecting to an HDMI input jack not compatible with ARC



Jack of TV to connect to: HDMI input jack (compatible with ARC) and, if needed, digital optical audio output jack

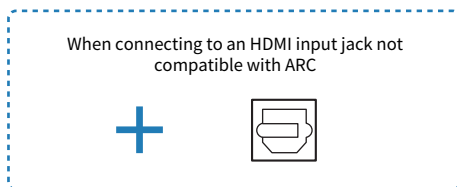

Connection procedure

“Connecting a TV using an HDMI cable (commercially available)” (p.26)

■ **TV without a digital optical audio output jack, but equipped with an HDMI input jack compatible with Audio Return Channel (ARC)**

Connect a TV using an HDMI cable. Prepare a commercially available HDMI cable compatible with ARC.

Cable: HDMI cable (commercially available)

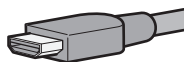

Jack of TV to connect to: HDMI input jack (compatible with ARC)



Connection procedure

“Connecting a TV using an HDMI cable (commercially available)” (p.26)

■ **TV without a digital optical audio output jack and also without an HDMI input jack compatible with Audio Return Channel (ARC)**

If the TV is equipped with an analog audio output jack or headphones jack, use one of these analog jacks to connect. Prepare a commercially available 3.5 mm stereo mini plug analog audio cable.

Cable: 3.5 mm stereo mini plug cable (commercially available)



Jack of TV to connect to: Analog audio output jack or headphones jack



Connection procedure

“Connecting an audio device” (p.30)

## Connecting a TV using only the included digital optical audio cable

- Before connecting devices, be sure to read the following precautions.
  - "Precautions for preparation" (p.18)

Connect a TV using the included digital optical audio cable.

The TV's audio signal is transmitted to the sound bar.

### 1 Connect a TV to the sound bar.

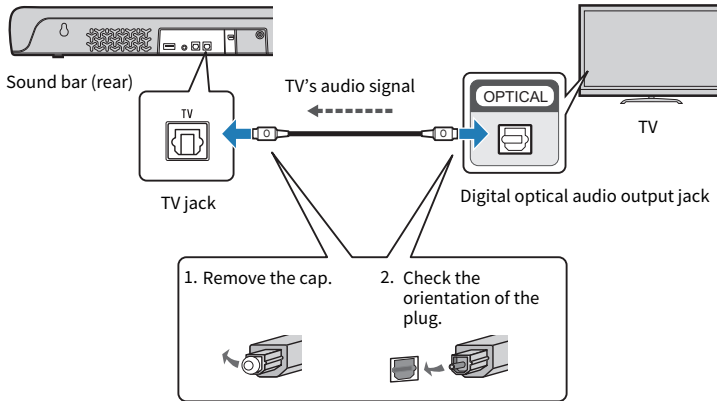

Cable to use



Digital optical audio cable (included)

## 2 Connect the sound bar and subwoofer to power.

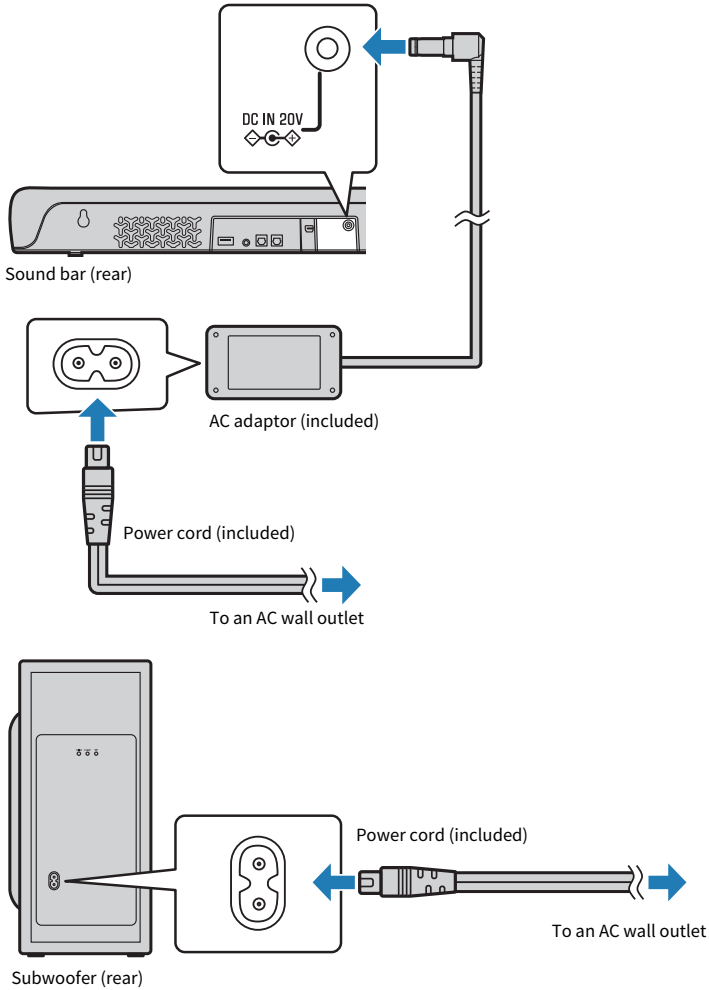

### NOTE

Connect an AV device (such as a set top box) to the TV.

## Connecting a TV using an HDMI cable (commercially available)

- Before connecting devices, be sure to read the following precautions.
  - “Precautions for preparation” (p.18)

If a TV is connected via an HDMI cable, the sound bar can be controlled by the HDMI Control function using the TV’s remote control.

### ■ Connecting to an HDMI input jack compatible with Audio Return Channel (ARC)

Connect the TV using an ARC-compatible HDMI cable (commercially available).

The HDMI cable transmits the TV’s audio signal and the control signal for controlling the sound bar using the TV’s remote control.

#### 1 Connect a TV to the sound bar.

Connect an HDMI cable to the HDMI input jack compatible with Audio Return Channel (labeled as “ARC”) on the TV.

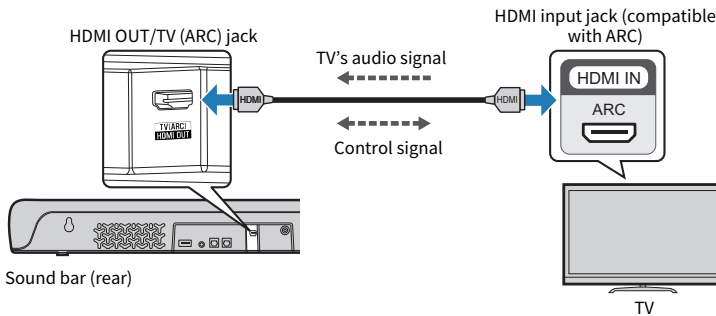

Cable to use



HDMI cable (commercially available)

## 2 Connect the sound bar and subwoofer to power.

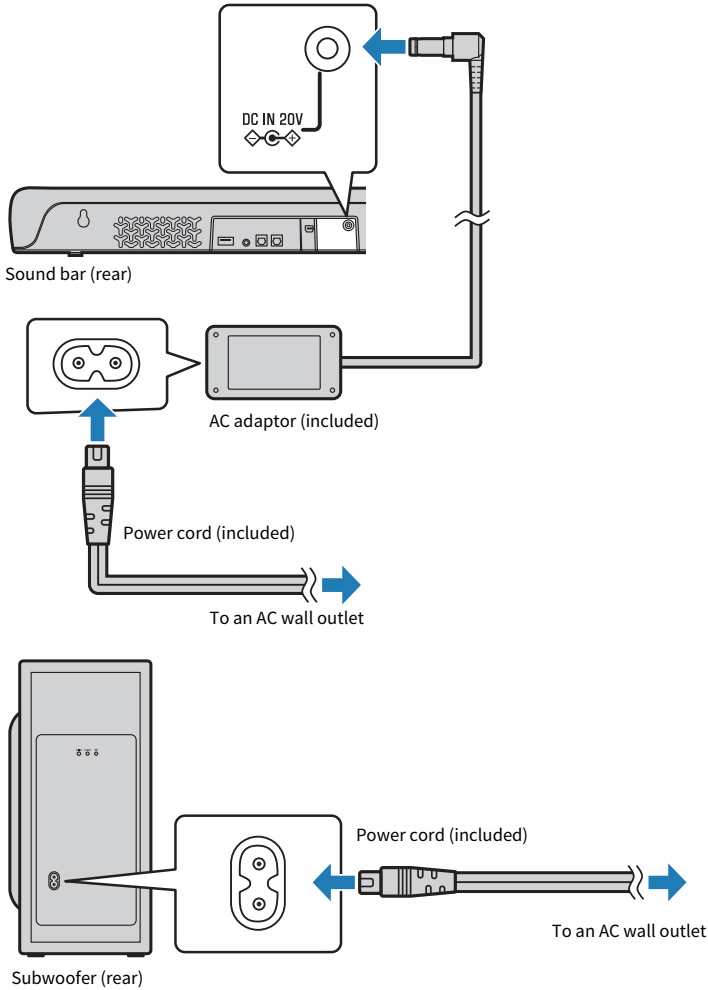

### ■ When connecting to an HDMI input jack not compatible with ARC

Connect the TV using an HDMI cable (commercially available) and included digital optical audio cable.

The digital optical audio cable transmits the TV's audio signal to the sound bar. The HDMI cable transmits the control signal for controlling the sound bar using the TV's remote control (HDMI Control function). If you do not want to use the HDMI Control function, you do not need to connect an HDMI cable.

# 1 Connect a TV to the sound bar.

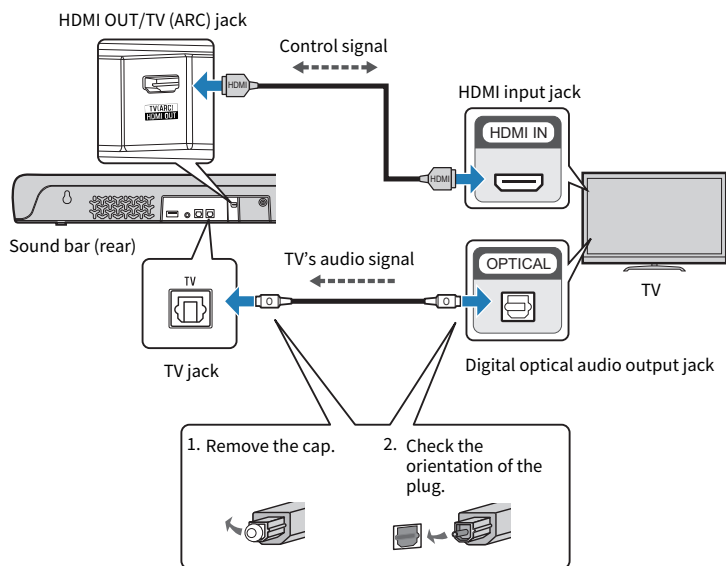

Cable to use

	Digital optical audio cable (included)
	HDMI cable (commercially available)



## 2 Connect the sound bar and subwoofer to power.

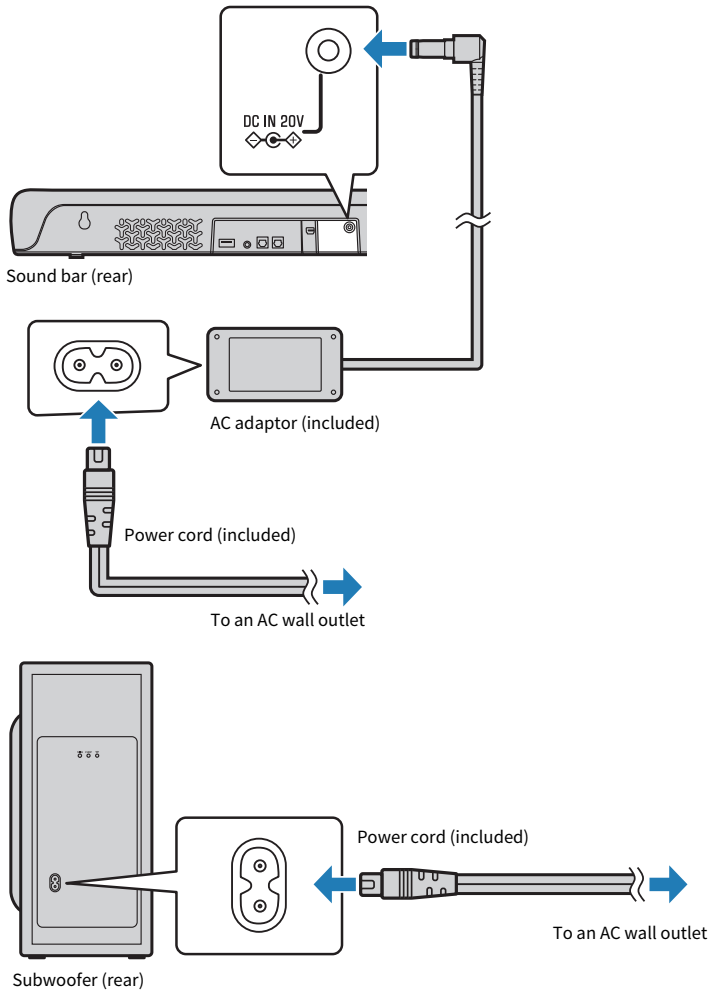

### NOTE

- When connected to an ARC-compatible HDMI input jack, enable the HDMI Control function of the sound bar. Default setting: Enabled
- Use a 19-pin HDMI cable with the HDMI logo printed on it.
- Use a cable that is as short as possible to prevent any degradation in signal quality.
- Connect an AV device (such as a set top box) to the TV.

### Related links

"Enabling/disabling the HDMI Control function" (p.52)

## Connecting an audio device

- Before connecting devices, be sure to read the following precautions.
  - “Precautions for preparation” (p.18)

Devices equipped with audio output jacks can be connected directly to the sound bar.

### ■ A device with a digital optical audio output jack

Connect an audio device using a digital optical audio cable.

#### 1 Connect an audio device to the sound bar.

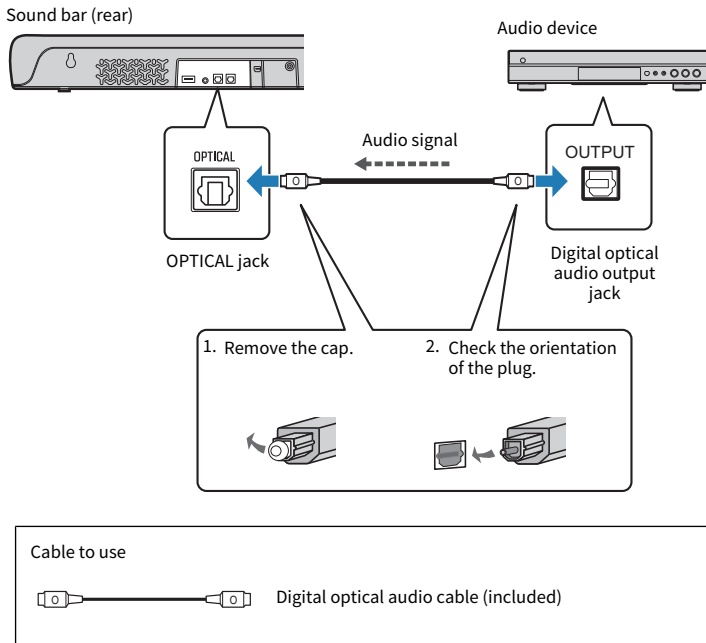

## 2 Connect the sound bar and subwoofer to power.

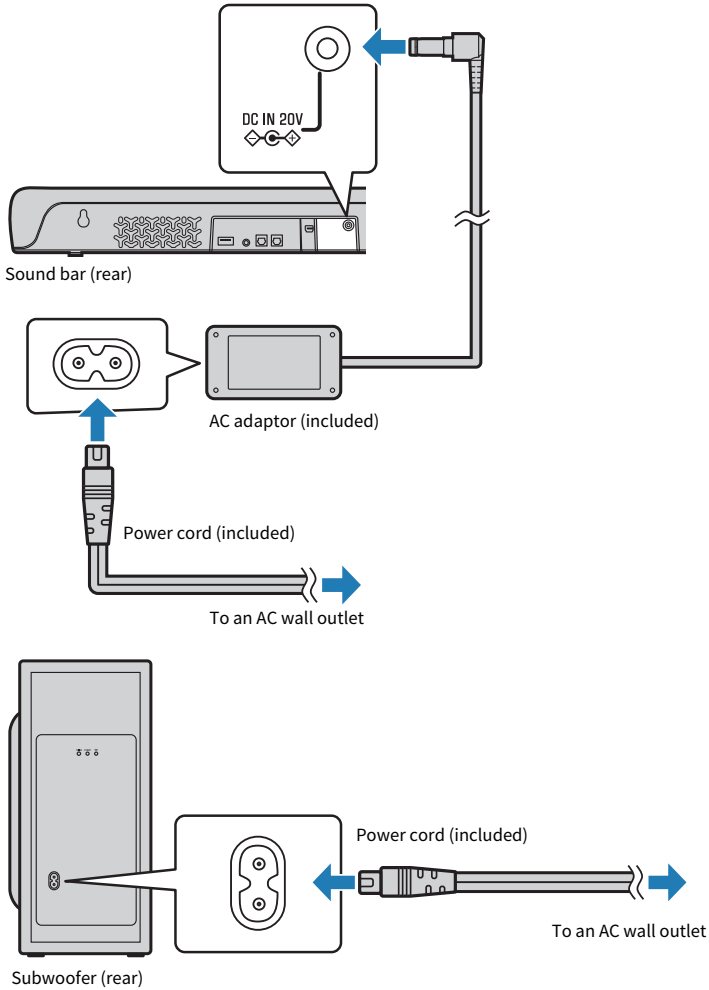

### NOTE

When connecting a device equipped with video output, connect the video output jack directly to the video input jack on the TV.

### ■ A device with an analog audio output jack

Connect an audio device using a 3.5 mm stereo mini plug cable (commercially available).

# 1 Connect an audio device to the sound bar.

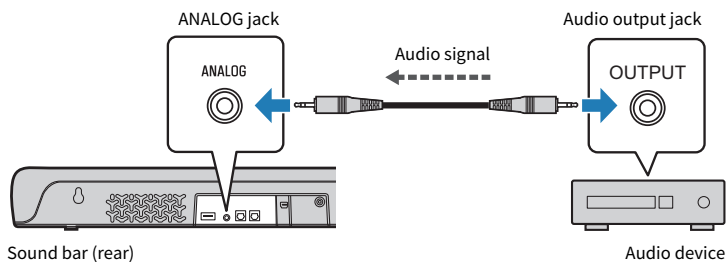

Cable to use



3.5 mm stereo mini plug cable (commercially available)

## 2 Connect the sound bar and subwoofer to power.

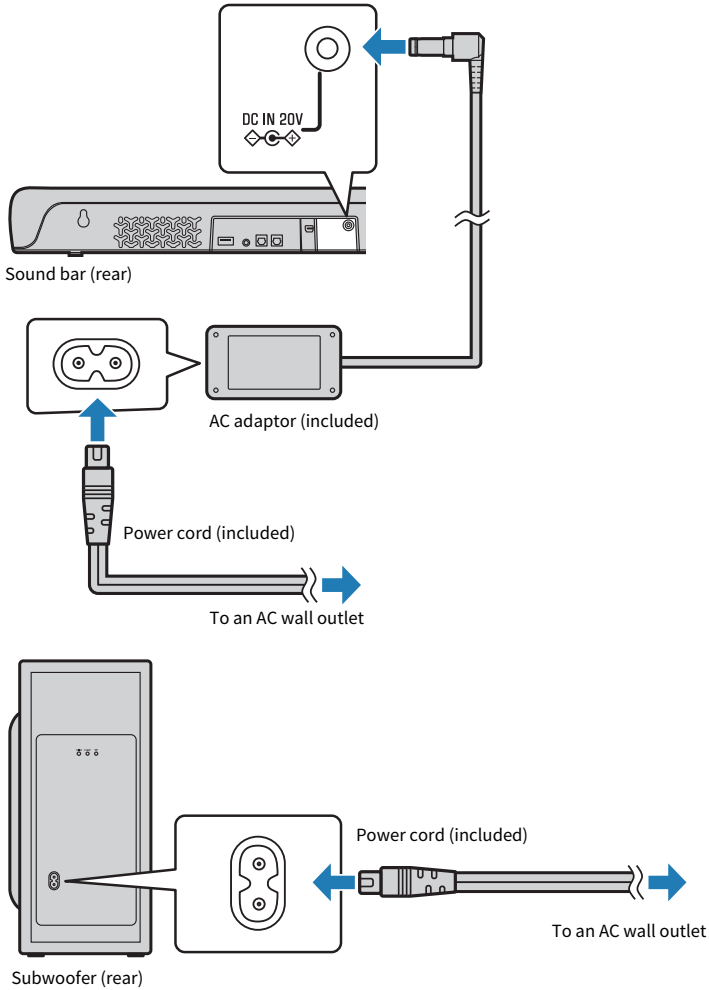

### CAUTION

- If the volume can be adjusted on a device connected to the ANALOG input jack of the sound bar, adjust the volume of the device so that the volume is about the same for both the TV and the device.

### NOTE

When connecting a device equipped with video output, connect the video output jack directly to the video input jack on the TV.

## Preparing the remote control

Remove the battery insulating strip before attempting to use the remote control.

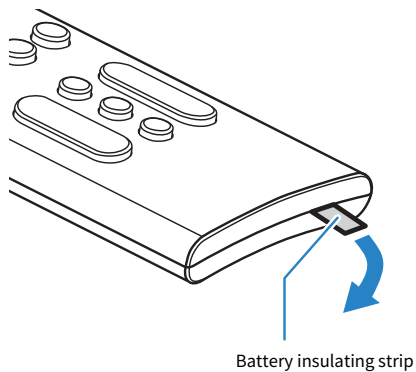

### Related links

["How to replace the remote control battery" \(p.82\)](#)

## Turning on and off the sound bar

Turn the sound bar on and off.

### 1 Press (power) button.

Pressing the button turns the sound bar on and off.

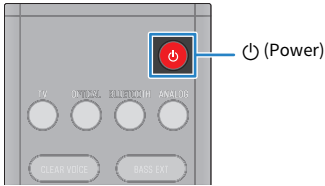



When the sound bar is turned on, all the indicators glow, and then some indicators remain glowing to show the setting status (normal display).



When the sound bar is turned off, the indicators go off.

### NOTE

- The same operation can also be performed from the sound bar's  (power) button.
- When the sound bar is turned on, the sound bar and subwoofer are automatically connected wirelessly. When the connection is established, the  indicator on the rear of the subwoofer glows.



# PLAYBACK

## Basic control during playback

This section describes the basic control operations available during playback.

### ■ Selecting an input source

Press one of the following buttons.

- TV button: Audio from a TV
- OPTICAL button: Audio from a device connected to the OPTICAL input jack
- BLUETOOTH button: Audio from a Bluetooth device
- ANALOG button: Audio from a device connected to the ANALOG input jack

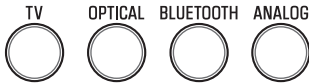

The indicator of the selected input source button glows.



One of the indicators glows

### ■ Adjusting volume

Press VOLUME (+/-) to adjust the volume.



The number of glowing indicators changes to show the volume level.

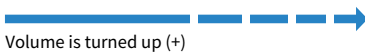



## PLAYBACK > Basic control during playback

If audio is being output from both the TV speakers and the sound bar, mute the TV.

To temporarily mute the sound bar, press . To unmute, press  again or press VOLUME (+/-).





While muted, the indicators will show the following.



Flashing

### NOTE

The same operations can also be performed from the sound bar's controls.

-  (Input): For selecting a device to play.
-  /  (Volume +/-): For adjusting the volume.

### Related links

- “Surround playback” (p.40)
- “Stereo playback” (p.41)
- “Playing back human voices clearly (CLEAR VOICE)” (p.43)
- “Enjoying rich bass sound (BASS EXT)” (p.44)
- “Listening to audio from a Bluetooth® device” (p.45)

## Adjusting the sound to your preference

### Sound functions of this product

---

This product is equipped with sound modes for surround playback and for stereo playback. There are also various sound settings for adjusting the sound to suit your preferences even better.

#### ■ Sound modes

A sound mode can be selected from among three sound modes for surround playback and one sound mode for stereo playback.

#### **STEREO**

This sound mode provides stereo playback. This sound mode is best suited for music playback.

#### **STANDARD**

This sound mode provides surround playback that is best suited for TV programs such as sports broadcasts. It emphasizes the acoustic image of human voices and makes the voices easier to hear, while reproducing a wide sound field.

#### **3D MOVIE**

This sound mode provides surround playback that is best suited for movies. It reproduces a three-dimensional sound field and creates a sound space that seems to envelop your body.

#### **GAME**

This sound mode provides surround playback that is best suited for video games. It accurately reproduces and emphasizes the localization of individual sound effects for a highly immersive gaming experience.

#### ■ Sound settings

The sound settings allow you to adjust the sound to better suit your preferences.

#### **Clear Voice**

The human voices within the audio can be heard more easily without turning up volume when the Clear Voice function is enabled. The function is recommended for enjoying movies or dramas at a low volume, and for movies or dramas that use a lot of background music and sound effects.

#### **Bass Extension**

The acoustic image of bass sound is enhanced when the Bass Extension function is enabled. It allows you to enjoy rich bass performance with a strong presence without disturbing the balance of the overall sound.

**Related links**

- “Surround playback” (p.40)
- “Stereo playback” (p.41)
- “Playing back human voices clearly (CLEAR VOICE)” (p.43)
- “Enjoying rich bass sound (BASS EXT)” (p.44)

## Surround playback

---

Press STANDARD, 3D MOVIE, or GAME to switch to surround playback. Select your preferred sound mode according to the content viewed or listened to.

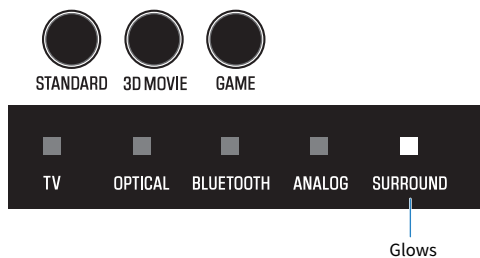

### Related links

[“Sound functions of this product” \(p.38\)](#)

## Stereo playback

---

Press STEREO to switch to 2-channel stereo playback.



Off

### Related links

[“Sound functions of this product” \(p.38\)](#)

## Adjusting the volume of the subwoofer

---

Adjust the volume of the subwoofer only.

Press SUBWOOFER (+/-) to adjust the volume.



SUBWOOFER

The glowing indicator changes to show the volume level.



Volume is turned down (-)

Volume is turned up (+)

## Playing back human voices clearly (CLEAR VOICE)

---

The human voices within the audio can be heard more easily without turning up volume when the Clear Voice function is enabled. The function is recommended for enjoying movies or dramas at a low volume, and for movies or dramas that use a lot of background music and sound effects.

Press CLEAR VOICE to enable or disable the function.

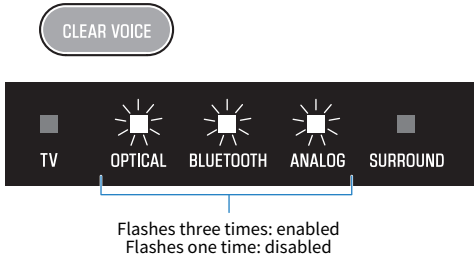

### NOTE

- Press INFO to see whether the Clear Voice function is enabled or disabled.
- Clear Voice is a function that focuses on and emphasizes the acoustic image of human voices within the audio. Only the human voices are emphasized without changing the overall volume and frequency characteristics, and it gives a clear sense of localization to the human voices.

### Related links

“Showing the type of audio signal and settings for functions” (p.50)

## Enjoying rich bass sound (BASS EXT)

---

The acoustic image of bass sound is enhanced when the Bass Extension function is enabled. It allows you to enjoy rich bass performance with a strong presence without disturbing the balance of the overall sound. This function is recommended when you want to increase the bass while suppressing the volume of the subwoofer, or when you want to emphasize the sounds of low-pitched instruments.

Press BASS EXT to enable or disable the function.

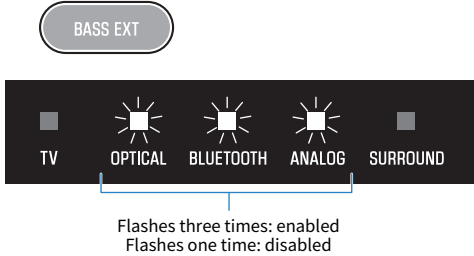

### NOTE

Press INFO to see whether the Bass Extension function is enabled or disabled.

### Related links

"Showing the type of audio signal and settings for functions" (p.50)



## Listening to audio from a Bluetooth® device

Audio content from a Bluetooth device can be played through the sound bar.

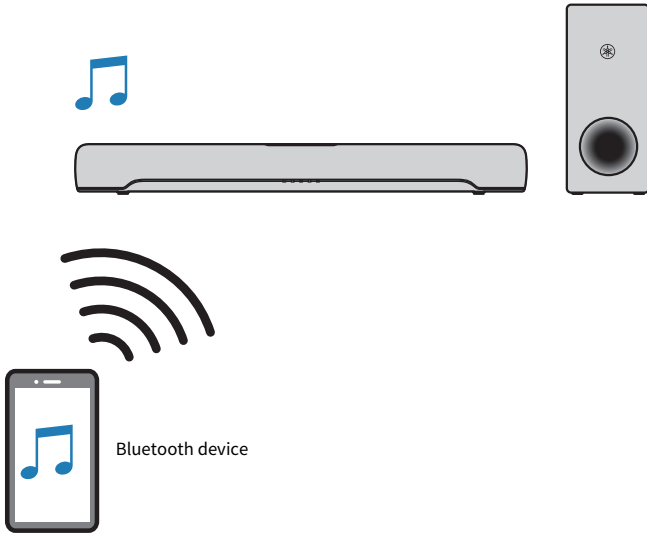

### 1 Press **BLUETOOTH** to switch the input source to Bluetooth.



The sound bar enters the connection wait status, and the BLUETOOTH indicator flashes.

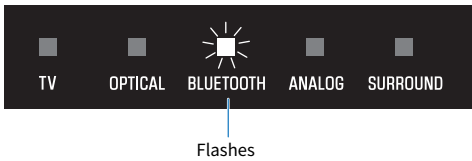

### 2 On the Bluetooth device, enable the Bluetooth function.

### 3 Select the sound bar on the Bluetooth device.

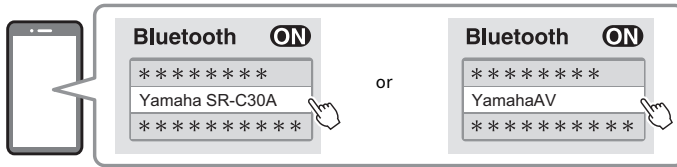

When the connection is established, the BLUETOOTH indicator on the sound bar stops flashing and starts glowing blue.

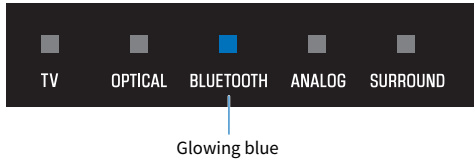

### 4 Start playback on the Bluetooth device.

The sound bar will begin playing audio from the Bluetooth device.

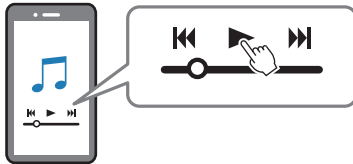

#### NOTE

- “Compressed Music Enhancer” is enabled during playback from a Bluetooth device to reproduce the rich, deep sound that the audio had prior to compression.
- Enabling the Bluetooth standby function allows the sound bar to be turned on automatically when a connection operation is performed with a Bluetooth device.
- If other Bluetooth devices have been connected before, the sound bar will connect to the last connected device when the input source is switched to Bluetooth.
- The Bluetooth connection is terminated if one of the following operations is performed.
  - The Bluetooth function of the Bluetooth device is turned off.
  - BLUETOOTH on the sound bar’s remote control is held down for at least five seconds.
  - An input source other than Bluetooth is selected on the sound bar.
  - Turn off the sound bar.
- Adjust the volume level of the Bluetooth device if necessary.
- Perform Bluetooth device operations within 10 m (33 ft) of the sound bar.

#### Related links

“Enabling/disabling the Bluetooth Standby function” (p.55)

### ■ Switching Bluetooth devices for playback (multipoint connection)

The sound bar can be connected to two Bluetooth devices simultaneously. It is easy to switch between the Bluetooth devices for playback.

PLAYBACK > Listening to audio from a Bluetooth® device

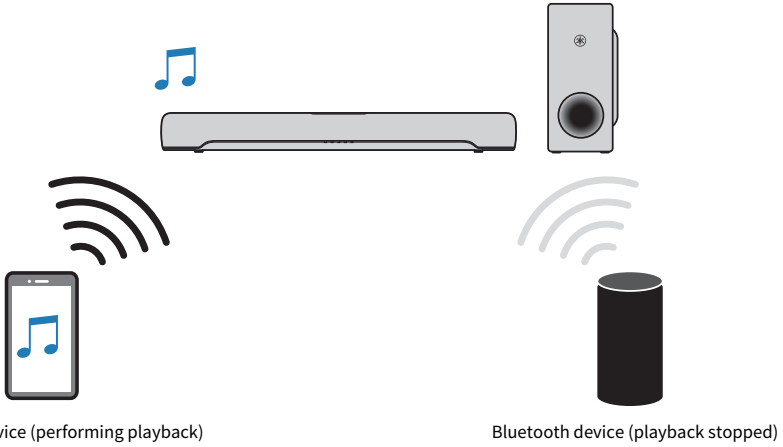

Perform the following procedures to switch between devices for playback.

- 1 Stop playback on the Bluetooth device.**
- 2 Start playback on the other Bluetooth device.**

Audio from the other Bluetooth device can be heard on the sound bar.

**NOTE**

When connecting a new Bluetooth device, disconnect the currently connected Bluetooth device and then connect the new device.

## ADDITIONAL FEATURES

### Changing the brightness of the indicators (Dimmer)

Change the brightness of the indicators of the sound bar to one of three levels: “Bright”, “Dim”, or “Off”. The brightness is “Dim” by default.

**1 Turn on the sound bar.**

**2 Press DIM.**



Press the button to change the brightness in the order of “Dim”, “Off” and “Bright”.

#### NOTE

Indicators glow brightly just after operation and then change to the specified brightness after a few seconds.

## Using a TV's remote control to control the sound bar (HDMI Control)

When the sound bar is connected to a TV via an HDMI cable, the sound bar can be controlled using the TV's remote control. This is called the HDMI Control function.

TV's remote control (example)

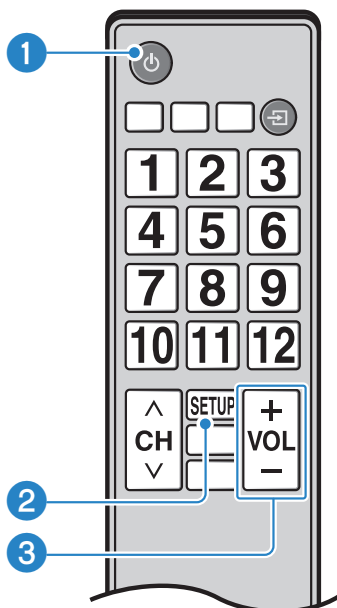

**1 Turn the power on and off**

Both the TV and the sound bar turn on/off at the same time.

**2 Switch the audio output device**

The audio output device can be switched to the TV or the sound bar. Control operations vary depending on the TV's type.

**3 Adjust volume**

The sound bar's volume can be adjusted when the TV's audio output is set to the sound bar.

### Related links

"Enabling/disabling the HDMI Control function" (p.52)

# Showing the type of audio signal and settings for functions

The type of audio signal being played and settings for the sound bar's functions can be checked.

## 1 Press INFO.



The indicators on the sound bar will show the following information on the type of audio signal and the settings for functions for three seconds immediately after INFO is pressed.

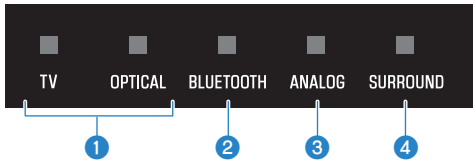

### 1 Type of audio signal

TV glows white: Dolby Digital

OPTICAL glows white: AAC

TV and OPTICAL off: PCM, analog, or no input signal

### 2 Whether Dolby Pro Logic II is enabled or disabled

Glow: enabled

Off: disabled

#### NOTE

Dolby Pro Logic II is enabled automatically when 2-channel stereo signals are played in surround.

### 3 Whether the Bass Extension function is enabled or disabled

Glow: enabled

Off: disabled

### 4 Whether the Clear Voice function is enabled or disabled

Glow: enabled

Off: disabled

## Controlling the sound bar with the smartphone app

By installing the free dedicated app “Sound Bar Remote” on a smartphone, the sound bar can also be controlled from that smartphone.

Search for “Sound Bar Remote” on the App Store or Google Play and install it on the mobile device.



After installing the app on your smartphone, connect to the sound bar via Bluetooth and open the app. The app allows you to control the sound bar while checking its current settings via the following simple screen.

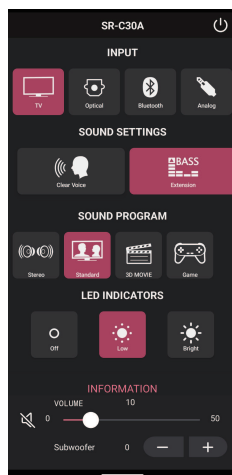

For details on the app, see the description of the app on the App Store or Google Play.

### NOTE

- This sound bar supports Sound Bar Remote only. This sound bar cannot be controlled using other apps (such as Sound Bar Controller).
- To control the sound bar using the app, configure the settings on the mobile device as follows:
  - Enable the Bluetooth function.
  - For devices using the Android 11 OS or earlier, configure the settings to allow location information to be obtained. The Sound Bar Remote app uses location information from the Android device only to detect the sound bar. The acquired location information will not be used for any other purpose.
  - For devices using the Android 12 OS or later, configure the settings to allow the use of nearby devices.

# CONFIGURATION

## Enabling/disabling the HDMI Control function

Enabling the HDMI Control function allows the sound bar to be controlled using the TV's remote control.

Default setting: Enabled

- 1 Turn off the sound bar.**
- 2 Hold down TV for at least five seconds.**



The HDMI Control function switches from enabled to disabled, or from disabled to enabled.

The indicator shows the setting status as follows, and the sound bar is turned on.



Glow: enabled  
Off: disabled

### NOTE

When connected to a TV's ARC-compatible HDMI input jack, enable the HDMI Control function.

### Related links

- “Connecting a TV using an HDMI cable (commercially available)” (p.26)
- “The sound bar cannot be controlled using the TV's remote control” (p.70)



## Enabling/disabling the Auto Power Standby function

Enabling the Auto Power Standby function turns off the sound bar in any of the following situations.

- No control operations for eight hours
- No audio input and no control operations for 20 minutes (except when ANALOG is selected as the input source)

The default setting varies depending on the model.

Models for U.S.A., Canada, Mexico, Australia, China and Taiwan: Disabled

Models for Europe, U.K., Korea, and other areas: Enabled

### 1 Turn off the sound bar.

### 2 While holding down on the sound bar, hold down for at least five seconds.



The Auto Power Standby function switches from enabled to disabled, or from disabled to enabled.

The indicator shows the setting applied as follows, and the sound bar is turned on.



Glow: disabled  
Off: enabled

## Enabling/disabling the Child Lock function

Locking the controls of the sound bar prevents accidental operation (Child Lock function).

Default setting: Disabled (no Child Lock)

- 1 Turn off the sound bar.**
- 2 Hold down INFO for at least five seconds.**



The Child Lock function switches from enabled to disabled, or from disabled to enabled.

The indicator shows the setting applied as follows, and the sound bar is turned on.



Glow: enabled (Child Lock)  
Off: disabled (no Child Lock)

## Enabling/disabling the Bluetooth Standby function

Enabling the Bluetooth Standby function allows the sound bar to be turned on automatically when a Bluetooth device connects to the sound bar.

Default setting: Enabled

- 1 Turn off the sound bar.**
- 2 Hold down BLUETOOTH for at least five seconds.**



The Bluetooth Standby function switches from enabled to disabled, or from disabled to enabled.

The indicator shows the setting applied as follows, and the sound bar is turned on.



Glows: enabled  
Off: disabled

## Enabling/disabling the Bluetooth function

The Bluetooth function can be disabled.

Default setting: Enabled

- 1 Turn off the sound bar.**
- 2 Hold down DIM for at least five seconds.**



The Bluetooth function switches from enabled to disabled, or from disabled to enabled.

The indicator shows the setting applied as follows, and the sound bar is turned on.



Glows: enabled  
Off: disabled



## Setting the dynamic range compression level

Compressing the dynamic range of audio signals (the volume difference between the loudest and quietest sounds) makes it easier to listen at a low volume. This setting is applied only when Dolby Digital audio signals are being played.

Default setting: No compression



### **1 Turn off the sound bar.**

## 2 Hold down one of the following buttons for at least five seconds.

Compression level	Function	Button of remote control
Maximum compression	Apply the maximum amount of dynamic range compression.	 STANDARD
Standard compression	Apply an amount of dynamic range compression well suited for a typical room.	 3D MOVIE
No compression	Dynamic range compression is not applied.	 GAME

The dynamic range compression level setting is changed.

The indicator shows the setting status as follows, and the sound bar is turned on.

Compression level	Sound bar's indicators
Maximum compression	 <p>TV OPTICAL BLUETOOTH ANALOG SURROUND</p> <p>Glowing red</p>
Standard compression	 <p>TV OPTICAL BLUETOOTH ANALOG SURROUND</p> <p>Glowing white</p>
No compression	 <p>TV OPTICAL BLUETOOTH ANALOG SURROUND</p> <p>Glowing white</p>

CONFIGURATION > Setting the frequency characteristics of the sound according to how the sound bar is installed

## Setting the frequency characteristics of the sound according to how the sound bar is installed

Switch the frequency characteristics of the sound bar so that the sound suits the way it is installed.

Default setting: Installed on a stand

### Wall-mounted

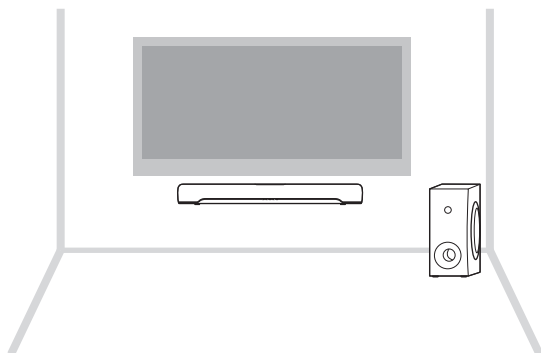

### Installed on a stand

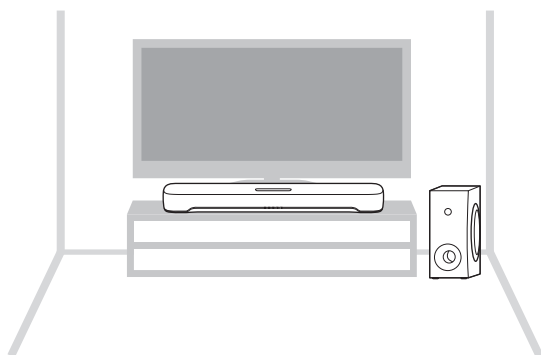

- 1 Turn off the sound bar.**

CONFIGURATION > Setting the frequency characteristics of the sound according to how the sound bar is installed

**2 According to how the sound bar is installed, hold down one of the following buttons for at least five seconds.**

- Wall-mounted



- Installed on a stand



The frequency characteristics setting is changed.

The indicator shows the setting status as follows, and the sound bar is turned on.

**Wall-mounted**

Sound bar's indicators

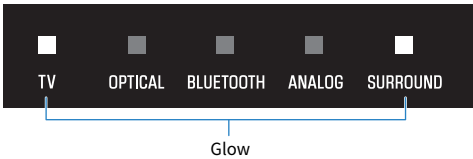

**Installed on a stand**

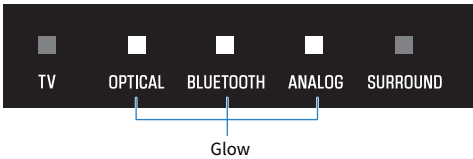

Sound bar's indicators





## Initializing the sound bar

Reset the settings of the sound bar to the factory presets.

- 1 The sound bar is turned off.**
- 2 While holding down  on the sound bar, hold down  until all indicators flash.**



Initialization is performed. When initialization is complete, the indicators will show the following.



Flash (initialization complete)

# TROUBLESHOOTING

## Check the following first when any problem occurs

Make sure of the following when the product does not function properly.

- The power cords of all the devices are connected to AC wall outlets securely.
- The product, TV and AV devices are turned on.
- The connectors of each cable are securely inserted into the jacks on each device.

### Related links

“List of support centers” (p.95)

## When a problem occurs: Power or overall functionality

### The power turns off suddenly

---

● **The Auto Power Standby function turned off the sound bar.**

Enabling the Auto Power Standby function turns off the sound bar automatically in any of the following situations.

- No control operations for eight hours
- No audio input and no control operations for 20 minutes (except when ANALOG is selected as the input source)

Turn on the sound bar again. The Auto Power Standby function can be disabled.

- “Enabling/disabling the Auto Power Standby function” (p.53)

● **The protection circuitry has been activated. (The TV indicator on the sound bar flashes red.)**

After confirming that all connections are made properly, turn on the sound bar again. If the power still turns off frequently, unplug the power cord from the AC wall outlet and contact the nearest authorized Yamaha dealer or service center.

- “List of support centers” (p.95)

## The power cannot be turned on

---

● **The protection circuitry has been activated three times consecutively.**

To protect the product, the power cannot be turned on. Unplug the power cord from the AC wall outlet and contact the nearest authorized Yamaha dealer or service center.

- “List of support centers” (p.95)

## **No operations can be performed from the sound bar's controls**

---

● **The controls of the sound bar are locked.**

Unlock the controls of the sound bar.

- “Enabling/disabling the Child Lock function” (p.54)

## **All indicators are off although the power is on (the power appears to be off)**

---

● **Indicator brightness is set to “Off”.**

Change the brightness.

- “Changing the brightness of the indicators (Dimmer)” (p.48)

## The sound bar does not function correctly

---

● **The internal microcomputer is frozen due to an external electric shock (such as lightning or excessive static electricity) or to a drop in the power supply voltage.**

- Unplug the power cords of the sound bar and subwoofer from the AC wall outlets, and then plug them in again after at least 10 seconds.

## The sound bar turns on by itself

---

● **Another Bluetooth device is being operated nearby.**

Terminate the Bluetooth connection with the sound bar.

- “Listening to audio from a Bluetooth® device” (p.45)



## **The sound bar cannot be controlled with the remote control**

---

● **The sound bar is out of the operating range.**

Use the remote control within the operating range.

- “Part names of the remote control” (p.14)

● **The battery has run out.**

Replace the battery with a new one.

- “How to replace the remote control battery” (p.82)

● **The remote control sensor of the sound bar is exposed to direct sunlight or strong lighting.**

Adjust the lighting angle or reposition the sound bar.

## The sound bar cannot be controlled using the TV's remote control

---

### ● The HDMI Control function is not properly configured.

Confirm that the settings are properly configured as follows:

- The HDMI Control function of the sound bar is enabled.
- The HDMI Control function is enabled on the TV.
- In the TV's HDMI settings, the audio output destination is set to an option other than the TV's built-in speakers.

If the sound bar still cannot be controlled with the TV's remote control, perform the following:

- Turn off the sound bar and the TV, and then turn them back on again.
- Unplug the power cord of the sound bar, as well as the power cords of external devices connected to the sound bar via an HDMI cable, from the AC wall outlet. Plug them in again after about 30 seconds.

### Related links

["Enabling/disabling the HDMI Control function" \(p.52\)](#)

### ● The TV does not support the sound bar's control functions.

Even if your TV supports the HDMI Control function, some functions may not be available. For details, see the documentation supplied with your TV.

## When a problem occurs: Audio

### No sound

---

● **The input source you are attempting to play back from is not selected.**

Select the correct input source.

- “Basic control during playback” (p.36)

● **The mute function is active.**

Cancel the mute function.

- “Basic control during playback” (p.36)

● **The volume is too low.**

Turn up the volume.

- “Basic control during playback” (p.36)

● **The power cord of the sound bar is not connected securely.**

Make sure that the power cord of the sound bar is properly connected to an AC wall outlet.

● **An input jack is connected to another input jack.**

Connect the input jack on the sound bar to the output jack on the AV device.

● **A signal that the sound bar cannot play is being input.**

Change the digital audio output setting on the TV or AV device to a type of audio signal supported by the sound bar.

- “Supported digital audio signal formats” (p.89)

● **The HDMI Control function is disabled.**

When connecting a TV that supports ARC (Audio Return Channel) to the sound bar using an HDMI cable only, enable the HDMI Control function.

To output audio from the sound bar when the HDMI Control function is disabled, connect the TV’s digital optical audio output jack to the sound bar’s TV jack (digital optical) via a digital optical audio cable.

- “Enabling/disabling the HDMI Control function” (p.52)
- “Connecting a TV using an HDMI cable (commercially available)” (p.26)

● **The audio output destination of a TV using HDMI Control is the TV’s built-in speakers.**

In the TV’s HDMI settings, set the audio output destination to an option other than the TV’s built-in speakers.

## No sound is coming from the subwoofer

---

● **The playback source does not contain subwoofer channel signals or low-frequency signals.**

Try to play content containing subwoofer channel signals, to see if any sound can be heard from the subwoofer.

● **The volume of the subwoofer is too low.**

Turn up the volume of the subwoofer.

- “Adjusting the volume of the subwoofer” (p.42)

● **The power cord of the subwoofer is not connected to an AC wall outlet.**

Connect the power cord of the subwoofer to an AC wall outlet.

● **The protection circuitry has been activated. (Both the STANDBY indicator and  indicator on the subwoofer are flashing.)**

To protect the product, the power of the subwoofer cannot be turned on. Unplug the power cord from the AC wall outlet and contact the nearest authorized Yamaha dealer or service center.

● **The  indicator on the subwoofer is flashing.**

The condition of the wireless connection is bad, and the subwoofer cannot be connected to the sound bar. Try the following.

- Place the subwoofer closer to the sound bar.
- If metal furniture is placed between the sound bar and subwoofer, change the layout or relocate the subwoofer.
- If a device emitting electromagnetic waves (such as a microwave oven or a wireless LAN device) is located nearby, place the subwoofer and sound bar farther away from it.

● **The subwoofer is waiting for pairing with the sound bar. (The STANDBY indicator on the subwoofer is flashing.)**

**If the sound from the subwoofer could be heard until now without any problem:**

The PAIRING button on the subwoofer was accidentally pressed, and the subwoofer has been in the pairing state.

Unplug the power cord of the subwoofer from the AC wall outlet, and then plug it in again after at least five seconds. Then, turn on the sound bar and it will function properly.

**If this problem occurs after performing a pairing operation:**

Pairing failed.

Unplug the power cord of the subwoofer from the AC wall outlet, and then plug it in again after at least five seconds. Check that the sound bar and subwoofer are installed properly, and try pairing the sound bar and subwoofer manually.

- “What to do if the sound bar and subwoofer are not paired automatically” (p.83)

## The volume decreases when the sound bar is turned on

---

● **The Automatic Volume Adjustment function lowered the volume.**

To prevent unexpected excessive loudness, the sound bar is equipped with the Automatic Volume Adjustment function. If the sound bar was turned off with the volume set high, the volume is automatically adjusted to a safe listening level the next time the sound bar is turned on. Turn up the volume if necessary.

- “Basic control during playback” (p.36)

## No surround effect

---

● **Stereo playback is selected.**

Select surround playback.

- “Surround playback” (p.40)

● **The volume is too low.**

Turn up the volume.

- “Basic control during playback” (p.36)

● **The TV or AV device is set to output 2-channel audio (such as PCM) only.**

Change the audio output setting on the TV or AV device to output Bitstream audio signals.

● **Sound is also heard from the TV’s built-in speakers.**

Turn the TV’s volume all the way down.

● **You are listening from a position that’s extremely close to the sound bar.**

You should listen at some distance from the sound bar.

## Noise is heard

---

- **The sound bar is too close to another digital or high-frequency device.**

Move those devices away from the sound bar.

## When a problem occurs: Bluetooth®

### The sound bar cannot be connected to a Bluetooth® device

---

● **Bluetooth is not selected as the input source of the sound bar.**

Select Bluetooth as the input source.

- “Listening to audio from a Bluetooth® device” (p.45)

● **The sound bar is too far away from the Bluetooth device.**

Move the Bluetooth device closer to the sound bar.

● **A device emitting electromagnetic waves (such as a microwave oven or a wireless device) is located nearby.**

Do not use the sound bar near devices that emit electromagnetic waves.

● **The Bluetooth device you are using does not support the A2DP profile.**

Use a Bluetooth device that supports the A2DP profile.

● **The connection profile registered in the Bluetooth device is not functioning correctly.**

Delete the connection profile in the Bluetooth device, and then connect the Bluetooth device to the sound bar.

● **The passkey for devices such as a Bluetooth adaptor is not “0000”.**

Use a Bluetooth device with a passkey of “0000”.

● **The sound bar is already connected to another Bluetooth device (when connecting a Bluetooth device for the first time).**

Terminate the current Bluetooth connection, and then connect to the new device.

● **The sound bar is already connected to two Bluetooth devices (when these devices have been connected to the sound bar before).**

Disconnect one of the currently connected Bluetooth devices, and then connect to another device.

● **The Bluetooth function of the sound bar is disabled.**

Enable the Bluetooth function.

- “Enabling/disabling the Bluetooth function” (p.56)



## No sound can be heard or the sound cuts off intermittently from a Bluetooth® device

---

- **The volume on the Bluetooth device is too low.**  
Raise the volume on the Bluetooth device.
- **Bluetooth is not selected as the input source of the sound bar.**  
Select Bluetooth as the input source.
  - “Listening to audio from a Bluetooth® device” (p.45)
- **Playback is not being performed on the Bluetooth device.**  
Perform playback on the Bluetooth device.
- **The audio output destination on the Bluetooth device is not set to the sound bar.**  
Select the sound bar as the audio output destination on the Bluetooth device.
- **The connection to the Bluetooth device was terminated.**  
Connect to the Bluetooth device again.
- **The sound bar is too far away from the Bluetooth device.**  
Move the Bluetooth device near the sound bar.
- **A device emitting electromagnetic waves (such as a microwave oven or a wireless device) is located nearby.**  
Do not use the sound bar near devices that emit electromagnetic waves.
- **Playback is being performed on another Bluetooth device.**  
Stop the current playback, and perform playback on the other Bluetooth device.

## When a problem occurs: App

### The app cannot detect the sound bar

---

● **An app not supported by the sound bar is being used.**

This sound bar supports Sound Bar Remote only. Sound Bar Controller, Home Theater Controller, and MusicCast Controller cannot be used.

● **The Bluetooth function on the mobile device is disabled.**

Enable the Bluetooth function on the mobile device.

● **On an Android device, the function for obtaining location information is disabled.**

The Sound Bar Remote app uses the location information of the Android device only to detect the sound bar. According to your Android device OS, change the settings as follows:

- For devices using the Android 11 OS or earlier, configure the settings to allow location information to be obtained.
- For devices using the Android 12 OS or later, configure the settings to allow the use of nearby devices.

## Other actions

### How to connect AV devices such as BD/DVD players

Connect AV devices, such as BD/DVD players and set top boxes, to the TV's HDMI input jacks.

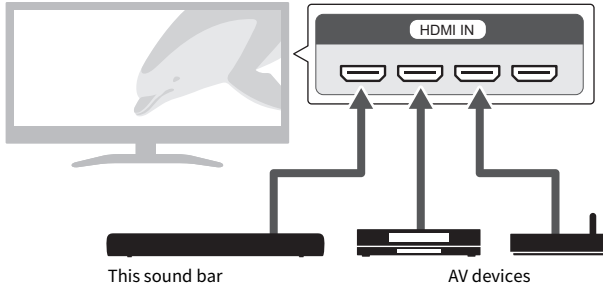

When playing audio from a TV or AV device via the sound bar, set the input sources as follows:

- Sound bar's input source: TV
- TV's input source: AV device playing the content

## How to minimize standby power consumption

---

Change the settings as follows:

- HDMI Control: Disabled
- Bluetooth Standby: Disabled

### Related links

- “Enabling/disabling the HDMI Control function” (p.52)
- “Enabling/disabling the Bluetooth Standby function” (p.55)

## Precautions for remote control batteries

---

Before replacing the remote control battery with a new one, be sure to read the following precautions. Be sure to follow the precautions.



### WARNING

- The remote control included with this product contains a coin/button cell battery. Do not ingest the coin/button battery. Keep new and used batteries away from children. If the battery compartment does not close securely, keep it away from children. If the coin/button cell battery is swallowed, it can cause severe chemical burns and dissolve tissues inside the body in less than 2 hours, and can lead to death. If you think batteries might have been swallowed or placed inside any part of the body, seek immediate medical attention.
- Do not dispose of a battery in fire. Do not expose a battery to high temperatures, such as direct sunlight or a fire. Do not attempt to charge the battery installed in the included remote control. The battery could burst or leak, causing a fire or injury.
- Do not disassemble a battery. If the battery leaks, avoid contact with the leaked fluid. If the contents of the battery get on your hands or in your eyes, it can cause blindness or chemical burns. If the battery fluid should come in contact with your eyes, mouth, or skin, wash immediately with water and consult a doctor.



### CAUTION

- Do not use a battery other than the specified one. Doing so may cause fire or burns, or result in fluid leakage that may cause skin inflammation.
- Always make sure the battery is inserted in conformity with the +/- polarity markings. Failure to do so might result in a fire, burns, or inflammation due to fluid leaks.
- When the battery runs out, or if the sound bar is not to be used for a long time, remove the battery from the remote control to prevent possible leakage of the battery fluid.
- Do not put in a pocket or bag, carry, or store batteries together with pieces of metal. The battery could short, burst, or leak, causing a fire or injury.
- When storing or discarding batteries, insulate the terminal area by applying tape, or some other protection. Mixing them with other batteries or metal objects can cause a fire, burns, or inflammation due to fluid.

## How to replace the remote control battery

- Before replacing the battery with a new one, be sure to read the following precautions.
  - “Precautions for remote control batteries” (p.81)

When the battery runs out, the sound bar can no longer be controlled with the remote control. Replace the battery with a new one.

### 1 Slide the cover in the direction of the arrow to remove it.

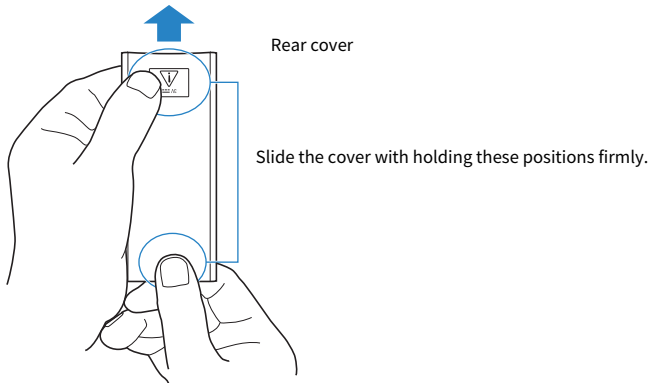

### 2 Remove the old battery and insert a new one.

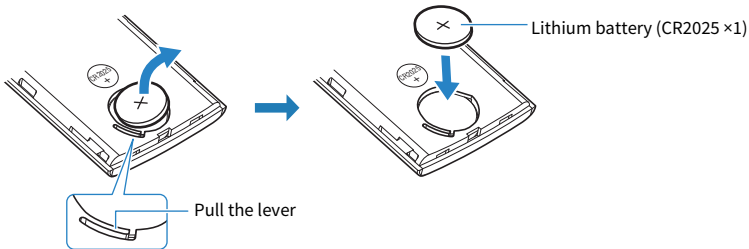

### 3 Slide the cover back into its position in the direction of the arrow.

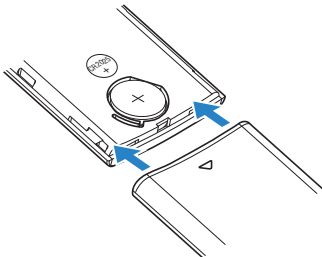

## What to do if the sound bar and subwoofer are not paired automatically

Normally, the sound bar and subwoofer are paired automatically, but if they are not properly paired due to a temporary communications failure, pair them manually.

### NOTE

Pairing is the process of having the sound bar and subwoofer recognize one another as devices to connect to.

- 1 Turn off the sound bar.**
- 2 Press and hold SUBWOOFER (-) on the remote control for at least five seconds.**

The sound bar is turned on, and the OPTICAL indicator on the sound bar flashes.

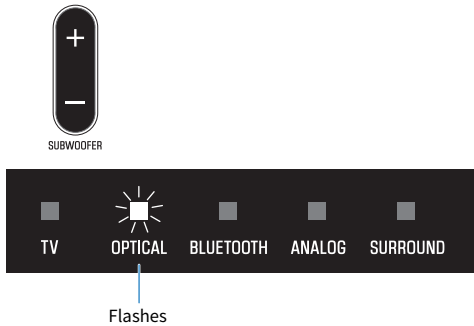

- 3 Within 30 seconds, press and hold PAIRING on the rear of the subwoofer for at least five seconds.**

When the sound bar and subwoofer have been paired successfully, the  indicator glows.

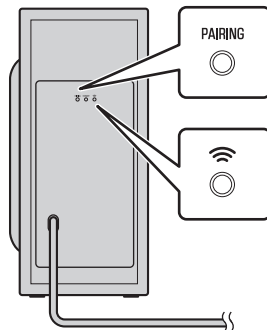

If the  indicator on the subwoofer does not glow after following the procedure above, do the following and then perform pairing manually again.

- Move the subwoofer and/or the sound bar so that they are closer to each other.

## TROUBLESHOOTING > Other actions

- Install the sound bar and subwoofer in positions where they are not obstructed from each other by metal furniture.
- If a device emitting electromagnetic waves (such as a microwave oven or a wireless LAN device) is located nearby, place the subwoofer and sound bar farther away from it.



## How to reset the sound bar

---

Reset the sound bar by performing the following operations.

### ■ To restart the sound bar

Unplug the power cords of the sound bar and subwoofer from the AC wall outlets, and then plug them in again after at least 10 seconds and turn on the power.

### ■ To initialize the sound bar

Refer to the following explanation and reset the settings of the sound bar to the factory presets.

“Initializing the sound bar” (p.61)

# APPENDIX

## Specifications

The specifications of this product are as follows.

### ■ Sound bar

#### Amplifier section

---

Maximum rated output power

- Front L/R 20 W × 2 channels

#### Speaker section

---

Front L/R

- Type Acoustic suspension type  
(non-magnetic shielding)
- Driver 4.6 cm (1-13/16") cone × 2
- Frequency response 210 Hz to 22 kHz
- Impedance 6 Ω

#### Decoder

---

Supported audio signal  
(HDMI (ARC)/optical input)

PCM (up to 2 channels)  
Dolby Digital (up to 5.1 channels)

#### Input jacks

---

Digital optical 2 (TV, OPTICAL)

Analog (3.5 mm stereo mini) 1 (ANALOG)

#### Output jacks

---

HDMI 1 (HDMI OUT/TV (ARC))

#### Other jacks

---

USB 1 (UPDATE ONLY)

## Bluetooth

Function	Sink function (source device to this unit)
Bluetooth version	Ver 5.0
Supported profiles	A2DP
Supported codecs	Sink function: SBC, AAC
Bluetooth class	Bluetooth Class 1
Range (line-of-sight)	Approx. 10 m (33 ft)
Supported content protection method	SCMS-T (sink function)
Models for U.K. and Europe	
<ul style="list-style-type: none"> <li>Radio frequency</li> </ul>	2402 MHz to 2480 MHz
<ul style="list-style-type: none"> <li>Maximum output power (EIRP)</li> </ul>	7.8 dBm (6.0 mW)

## General

Power supply	
<ul style="list-style-type: none"> <li>Models for U.S.A., Canada, Taiwan and Mexico</li> </ul>	AC 100 to 120 V, 50/60 Hz
<ul style="list-style-type: none"> <li>Models for U.K., Europe, and other areas</li> </ul>	AC 100 to 240 V, 50/60 Hz
Power consumption (AC adaptor output voltage/current)	20 V/2.1 A
Standby power consumption	
<ul style="list-style-type: none"> <li>[Models for U.S.A., Canada, Taiwan and Mexico] <ul style="list-style-type: none"> <li>HDMI Control/Bluetooth Standby: Off</li> <li>HDMI Control/Bluetooth Standby: On</li> </ul> </li> <li>[Models for U.K., Europe, and other areas] <ul style="list-style-type: none"> <li>HDMI Control/Bluetooth Standby: Off</li> <li>HDMI Control/Bluetooth Standby: On</li> </ul> </li> </ul>	0.3 W 0.5 W 0.3 W 0.5 W
Dimensions (W x H x D)	
<ul style="list-style-type: none"> <li>Installing the Sound Bar in front of a TV, etc.</li> </ul>	600 × 64 × 94 mm (23-5/8" × 2-1/2" × 3-3/4")
<ul style="list-style-type: none"> <li>Mounting the Sound Bar on a wall, with spacers</li> </ul>	600 × 64 × 102 mm (23-5/8" × 2-1/2" × 4")
Weight	1.3 kg (2.9 lb)

## NOTE

The contents of this User Guide apply to the latest specifications as of the publishing date. The latest version of the User Guide is available to download from the Yamaha website.

## ■ Subwoofer

### Amplifier section

---

Maximum rated output power	50 W
----------------------------	------

### Speaker section

---

• Type	Bass reflex (non-magnetic shielding)
• Driver	13 cm (5-1/8") cone × 1
• Frequency response	40 Hz to 210 Hz
• Impedance	3 Ω

### Wireless function (Wireless communication between the sound bar and subwoofer)

---

• Radio frequency band	2.4 GHz
• Transmission range	Approx. 10 m ([33 ft] without interference)

#### Models for U.K. and Europe

---

• Radio frequency	2405.35 MHz to 2477.35 MHz
• Maximum output power (EIRP)	9.0 dBm (7.9 mW)

### General

#### Power supply

---

• Models for U.S.A., Canada, Taiwan and Mexico	AC 100 to 120 V, 50/60 Hz
• Models for U.K., Europe, and other areas	AC 100 to 240 V, 50/60 Hz

---

Power consumption	20 W (Rated)
-------------------	--------------

---

Standby power consumption	0.8 W
---------------------------	-------

#### Dimensions (W x H x D)

---

• Installing the subwoofer upright, with non-skid pads	160 × 337 × 364 mm (6-1/4" × 13-1/4" × 14-3/8")
• Installing the subwoofer horizontal, with non-skid pads	335 × 162 × 364 mm (13-1/4" × 6-3/8" × 14-3/8")

---

Weight	5.7 kg (12.6 lb)
--------	------------------

### NOTE

The contents of this User Guide apply to the latest specifications as of the publishing date. The latest version of the User Guide is available to download from the Yamaha website.

## Supported digital audio signal formats

The following digital audio signals are supported by this product.

### TV, OPTICAL, and TV (ARC)

Audio formats	Details
2-channel Linear PCM	2 channels, 32 / 44.1 / 48 / 88.2 / 96 kHz, up to 24-bit
Bitstream	Dolby Digital

### NOTE

The contents of this User Guide apply to the latest specifications as of the publishing date. The latest version of the User Guide is available to download from the Yamaha website.

## List of indicator displays

The indicators of this product display information primarily in the following ways:

### ■ Sound bar's indicators

#### NOTE

This document shows indicator glowing status as follows:



Off



Glowing



Flashing

### Power off state



### Normal playback state

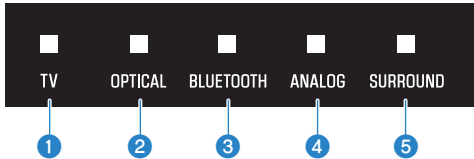

#### 1 TV

Glowing: Playing audio from the TV

#### 2 OPTICAL

Glowing: Playing audio from the OPTICAL input jack

#### 3 BLUETOOTH

Glowing blue: Bluetooth device connection established  
Flashing white: Bluetooth device connection wait status

#### 4 ANALOG

Glowing: Playing audio from the ANALOG input jack

#### 5 SURROUND

Glowing white: Surround playback

Off: Stereo playback

### Showing the type of audio signal and settings for functions

The indicators on the sound bar will show the following information on the type of audio signal and the settings for functions for three seconds immediately after INFO is pressed.

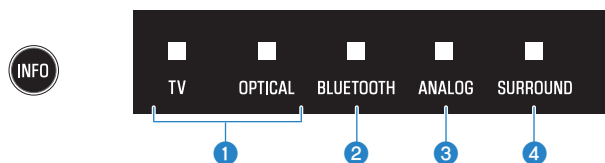

#### 1 Type of audio signal

TV glows white: Dolby Digital

OPTICAL glows white: AAC

TV and OPTICAL off: PCM, analog, or no input signal

#### 2 Whether Dolby Pro Logic II is enabled or disabled

Glow: enabled

Off: disabled

#### NOTE

Dolby Pro Logic II is enabled automatically when 2-channel stereo signals are played in surround.

#### 3 Whether the Bass Extension function is enabled or disabled

Glow: enabled

Off: disabled

#### 4 Whether the Clear Voice function is enabled or disabled

Glow: enabled

Off: disabled

### Muted state



### An error occurred



Flashes red

#### NOTE

- When the brightness of the indicators is set to “Off”, the indicators glow only during control operations.
- See the description of each setting for what the indicators will show when the setting is changed.

**Related links**

- “Basic control during playback” (p.36)
- “Showing the type of audio signal and settings for functions” (p.50)
- “Changing the brightness of the indicators (Dimmer)” (p.48)
- “When a problem occurs: Power or overall functionality” (p.63)

**Information displayed by the indicators of the subwoofer**

**NOTE**

This document shows indicator glowing status as follows:



Off



Glowing



Flashing

**Power on state**



**Power off state**



**Establishing a connection to the sound bar**



**Waiting for pairing with the sound bar**



**An error occurred and the protection circuitry has been activated**





## Trademarks



Dolby, Dolby Audio, Pro Logic, and the double-D symbol are trademarks of Dolby Laboratories Licensing Corporation. Manufactured under license from Dolby Laboratories.  
Confidential unpublished works. Copyright © 2012–2021 Dolby Laboratories. All rights reserved.



HIGH-DEFINITION MULTIMEDIA INTERFACE

The terms HDMI and HDMI High-Definition Multimedia Interface, and the HDMI Logo are trademarks or registered trademarks of HDMI Licensing Administrator, Inc. in the United States and other countries.



The Bluetooth® word mark and logos are registered trademarks owned by Bluetooth SIG, Inc. and any use of such marks by Yamaha Corporation is under license. Other trademarks and trade names are those of their respective owners.

## About third party software programs

This sound bar uses third party software programs.

For the copyright and the license agreement terms and conditions of third party software programs that are used, see the following website.

<https://manual.yamaha.com/av/cm/sla/22/src30a/>

## List of support centers

If the trouble still cannot be solved, please contact us for product support as shown below.

### **For customers within Japan**

- Please contact the store where you purchased this product, or the Product Support Center as listed in the “Safety Brochure” included with this product.

### **For customers outside of Japan**

- Please contact your nearest authorized Yamaha dealer or service center.  
<https://manual.yamaha.com/av/support/>

Yamaha Global Site  
<https://www.yamaha.com/>

Yamaha Downloads  
<https://download.yamaha.com/>

© 2022 Yamaha Corporation

Published 05/2022 NV-A0

AV21-0115



Sound Bar  
Barre de son  
Barra de Sonido

# SR-C30A

Quick Start Guide ..... 3

EN

Guide de démarrage rapide ..... 11

FR

Guía de inicio rápida ..... 19

ES

Thank you for purchasing this Yamaha product.

This product is a bar-shaped speaker system that can be used by connecting it to a TV. Audio content from a Bluetooth® device can also be played through the sound bar.

- Be sure to read this document and the included Safety Brochure to ensure proper and safe use. Keep these documents readily available for future reference.

### **Safety Brochure**

Be sure to read the Safety Brochure first to ensure safe use.



### **Quick Start Guide (this document)**

This document describes the procedure for enjoying the sound of a TV or Bluetooth device and the main functions.

- Confirming contents of product package (p. 4)
- Preparing the remote control (p. 5)
- Installing the product (p. 5)
- Connecting a TV (p. 6)
- Connecting to power (p. 8)
- Playing TV sound through the sound bar (p. 8)
- Adjusting the sound to your preference (p. 9)
- Listening to audio from a Bluetooth® device (p. 10)
- Controlling the sound bar via the smartphone app (p. 10)



### **User Guide**

More detailed information is described.

<https://manual.yamaha.com/av/22/src30a/>



# Confirming contents of product package

This product includes the following main devices and accessories. Take out all items from the box and make sure that all items are present.

## ■ Main devices



Sound bar (SR-CUC30A)

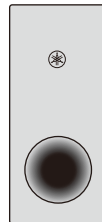

Subwoofer (SR-WSWC30A)

## ■ NOTE

- An HDMI cable is not included with this product. Prepare a commercially available one.

## ■ Accessories



Remote control



Power cords (x2)

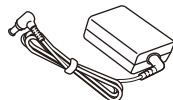

AC adaptor  
(Model number:  
ANAD-420FIOT-B)



Digital optical audio cable



Non-skid pads (4 on 1 sheet)  
Attach these to the bottom of the subwoofer.

Use when mounting the sound bar on a wall.



Spacers (A: x2, B: x2 on 1 sheet)



Mounting template

- Quick Start Guide (this document)
- Safety Brochure

## Preparing the remote control

A Lithium battery (CR2025) has already been inserted into the remote control. Pull out the insulation sheet as follows so as to use the remote control.

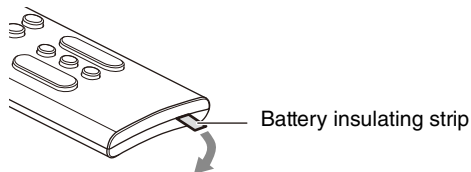

## Operating range of the remote control

The remote control can be used to control the functions of this product. When using the remote control, point the remote control at the remote control sensor of the sound bar within the range shown in the following illustration:

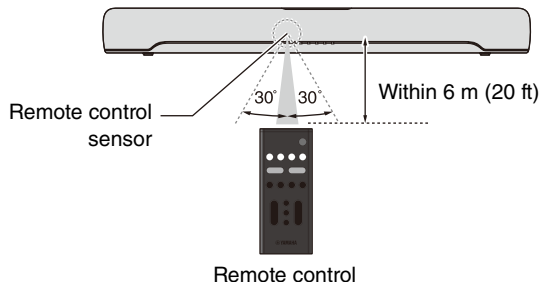

## Installing the product

Install the sound bar and subwoofer as shown in the following illustration:

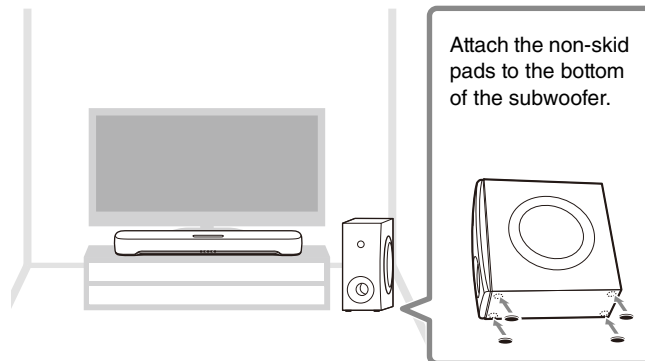

### ■ NOTE

- The subwoofer can also be used on its side. See the User Guide for details.



User Guide

For the proper installation of the sound bar on a wall, make sure to have it done by a qualified contractor. See the Wall Mounting Installation Guide on our website for the installation method.







Wall Mounting  
Installation Guide



## Connecting a TV

Connect a TV to the sound bar. Select the connection procedure according to the function to be used. The differences depending on the connection procedure are as follows:

### Function and connection procedure

	HDMI Control function <sup>1)</sup>	Jack of TV to connect to	Connection procedure
Digital optical audio cable (included) 	—	Digital optical audio output jack 	"Connecting a TV using the digital optical audio cable (included)" (on the right)
HDMI cable (commercially available) 	✓	HDMI input jack (ARC compatible <sup>2)</sup> ) 	"Connecting a TV using an HDMI cable (commercially available)" (on the next page)

<sup>1)</sup> The HDMI Control function allows the sound bar to be controlled using the TV's remote control. The following functions can be controlled using the TV's remote control:

- Turn the power on and off  
Both the TV and the sound bar turn on/off at the same time.
- Volume adjustment  
The sound bar's volume can be adjusted when the TV's audio output is set to the sound bar.

<sup>2)</sup> When connecting to an HDMI input jack not compatible with ARC, connect with both an HDMI cable and a digital optical audio cable.

### ■ NOTE

- The type and quality of the TV audio signal transmitted by either the digital optical audio cable or the HDMI cable is the same.

## Connecting a TV using the digital optical audio cable (included)

The TV's audio signal is transmitted to the sound bar when the sound bar is connected to a TV using the included digital optical audio cable. The HDMI Control function that controls the sound bar using a TV's remote control cannot be used.

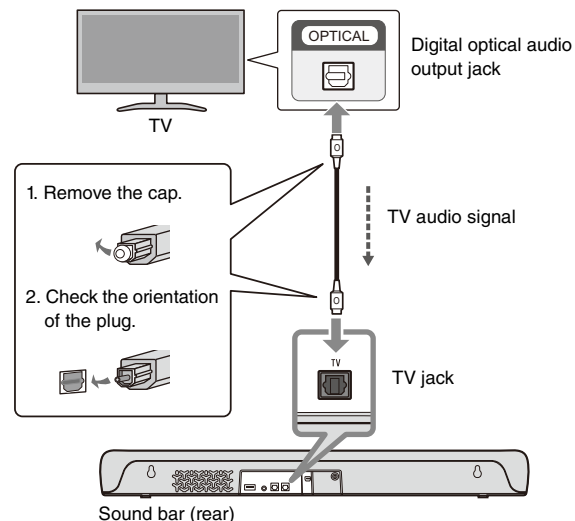

### ■ NOTE

- Connect AV devices (such as BD/DVD players and set top boxes) to the TV's HDMI input jacks.

## Connecting a TV using an HDMI cable (commercially available)

Control signals are transmitted from the TV to the sound bar when the sound bar is connected to a TV using an HDMI cable (commercially available). This will enable you to use the HDMI Control function that controls the sound bar using the TV's remote control.

If the HDMI cable is connected to the TV's HDMI input jack compatible with Audio Return Channel (labeled as "ARC"), the TV audio signal is also transmitted to the sound bar via the HDMI cable. Therefore, a TV can be connected to the sound bar using a single HDMI cable.

When connecting to an HDMI input jack not compatible with ARC, also connect the included digital optical audio cable to transmit the TV audio signal to the sound bar.

### Connecting to an ARC-compatible HDMI input jack

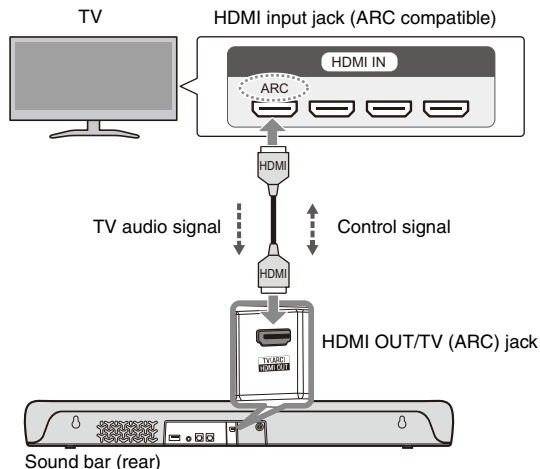

### Connecting to an HDMI input jack not compatible with ARC

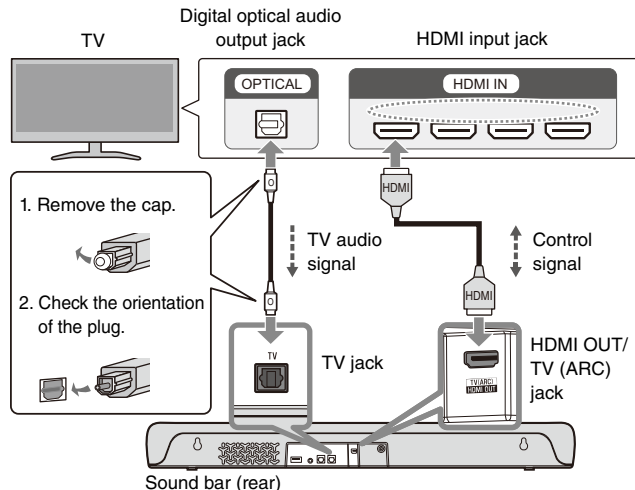

#### ■ NOTE

- When the sound bar is connected to a TV via an HDMI cable, confirm that the TV's settings are properly configured as follows:
  - The TV's HDMI Control function is enabled.
  - The TV's audio output is set to ARC (when an ARC-compatible HDMI input jack is connected).
- Connect AV devices (such as BD/DVD players and set top boxes) to the TV's HDMI input jacks.

## Connecting to power

After connecting the sound bar to the TV, connect the sound bar and subwoofer to power as follows:

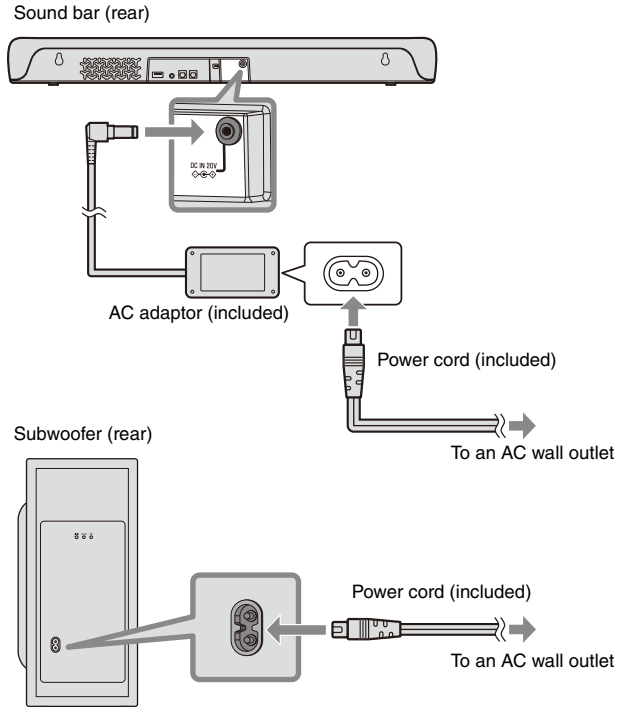

## Playing TV sound through the sound bar

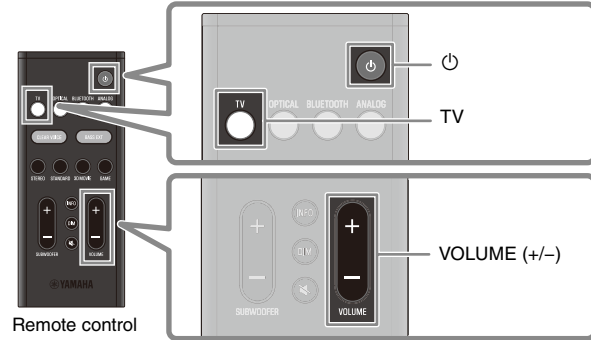

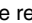
- 1 Turn on the TV.**  
When the HDMI Control function of the TV is enabled, the sound bar will also turn on. In this case, go to Step **4**.
- 2 Turn on the sound bar.**  
Press the  (power) button on the remote control.  
The power of the subwoofer also turns on at the same time.
- 3 Press TV.**
- 4 Press VOLUME (+/-) to adjust the volume.**

# Adjusting the sound to your preference

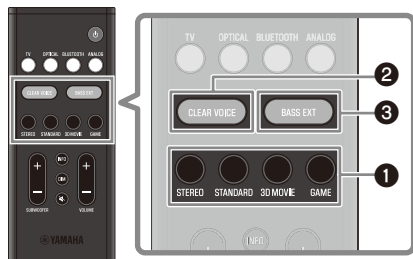

Remote control

## 1 Listening to audio with sound that matches the video or music content (Sound mode)

A sound mode can be selected from among three sound modes that produce surround-sound fields and one sound mode for stereo playback.

### STEREO

This sound mode provides stereo playback. It is the sound mode best suited for music playback.

### STANDARD

This sound mode provides surround playback that is best suited for TV programs such as sports broadcasts. It emphasizes human voices and makes them easier to hear, while creating a sense of presence.

### 3D MOVIE

This sound mode provides surround playback that is best suited for movies. It reproduces a three-dimensional sound field and creates a sound space that seems to envelop your body.

### GAME

This sound mode provides surround playback that is best suited for video games. Accurate localization of individual sound effects provides a highly immersive gaming experience.

## 2 Playing back human voices clearly (CLEAR VOICE)

The human voices within the audio can be heard more easily when the Clear Voice function is enabled. The function is recommended for playback at a low volume and for movies or dramas that use a lot of background music and sound effects.

Press CLEAR VOICE to enable or disable this function.

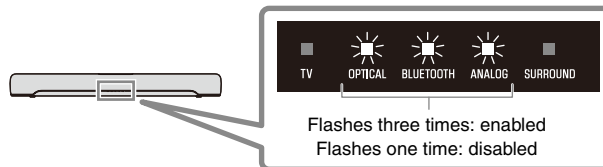

## 3 Enjoying rich bass sound (BASS EXT)

The bass sound is enhanced and becomes richer when the Bass Extension function is enabled.

Press BASS EXT to enable or disable this function.

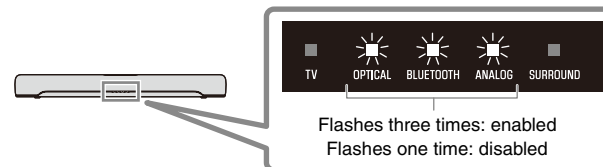

### ■ NOTE

The default settings are as follows:

Sound mode: STANDARD

CLEAR VOICE: Disabled

BASS EXT: Enabled

## Listening to audio from a Bluetooth® device

Audio content from a Bluetooth device (such as a smartphone) can be played through the sound bar.

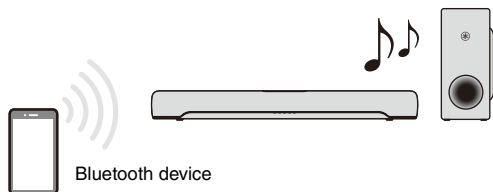

**1 Press BLUETOOTH on the remote control to switch the input source to Bluetooth.**

**2 On the Bluetooth device, enable the Bluetooth function.**

A list of Bluetooth devices that can be connected is displayed on the screen of the Bluetooth device.

**3 Select your product displayed within the list.**

“Yamaha SR-C30A” or “Yamaha AV” is displayed within the list.

**4 Play a song on the Bluetooth device.**

The sound bar will begin playing audio from the Bluetooth device.

### ■ NOTE

- The sound bar can be connected to two Bluetooth devices simultaneously. You will need to stop playback on the one Bluetooth device and then start playback on the other Bluetooth device.

## Controlling the sound bar via the smartphone app



By installing the free dedicated app “**Sound Bar Remote**” on a smartphone, the sound bar can also be controlled from that smartphone. The app allows you to control the sound bar while checking the sound bar settings currently applied, such as sound mode, via the app’s screen.

Search for “**Sound Bar Remote**” on the App Store or Google Play and install it on the smartphone.

For details on the app, see the description of the app on the App Store or Google Play.

### ■ NOTE

- To control the sound bar using the app, configure the settings on your smartphone as follows:
  - Enable the Bluetooth function.
  - For devices using the Android 11 OS or earlier, configure the settings to allow location information to be obtained. The Sound Bar Remote app uses location information from the Android device only to detect the sound bar. The acquired location information will not be used for any other purpose.
  - For devices using the Android 12 OS or later, configure the settings to allow the use of nearby devices.
- This sound bar is only compatible with the Sound Bar Remote app. The sound bar cannot be controlled using other apps (such as Sound Bar Controller).

YAMAHA CORPORATION

10-1 Nakazawa-cho, Naka-ku, Hamamatsu, 430-8650 Japan

Yamaha Global Site  
<https://www.yamaha.com/>  
Yamaha Downloads  
<https://download.yamaha.com/>

© 2022 Yamaha Corporation  
Published 05/2022  
KSOD-A0

VFS3060

U



# Wall Mounting Installation Guide

Sound Bar

**SR-C30A    ATS-C300**

**SR-C20A    ATS-C200**

# CONTENTS

<b>About this Wall Mounting Installation Guide .....</b>	<b>3</b>
<b>Precautions .....</b>	<b>4</b>
<b>Items to use for wall mounting installation .....</b>	<b>5</b>
<b>Mounting the sound bar on a wall .....</b>	<b>6</b>



# About this Wall Mounting Installation Guide

- This guide explains the installation method for qualified service personnel who mount the sound bar on a wall.
- This guide uses the following signal words for important information.



## **CAUTION**

This content indicates “risk of injury.”

### • **NOTICE**

Indicates points that you must observe in order to prevent product failure, damage, or malfunction, as well as to protect the environment.

### • **NOTE**

Indicates notes on instructions, restrictions on functions, and additional information that may be helpful.

- The illustrations in this guide are for instructional purposes only.
- The company names and product names in this User Guide are the trademarks or registered trademarks of their respective companies.

## **NOTE**

- The Safety Brochure and the Quick Start Guide are included with this product. General precautions for handling this product are described in the Safety Brochure. See this document before installing the sound bar.
- For details on the functions, see the User Guide of your product.
  - SR-C30A  
<https://manual.yamaha.com/av/22/src30a/>
  - SR-C20A  
<https://manual.yamaha.com/av/20/src20a/>
  - ATS-C300  
<https://manual.yamaha.com/av/22/atasc300/>
  - ATS-C200  
<https://manual.yamaha.com/av/20/atasc200/>

# Precautions

Before mounting the sound bar on a wall, be sure to read the following precautions for safe installation. Be sure to follow the precautions.

## ■ Precautions for mounting the sound bar on a wall



### CAUTION

- For proper installation of the sound bar on a wall, make sure to have the work done by the dealer from which you purchased the product or by a qualified contractor. Some skills and experience are required for safe installation.
- Be sure to follow the precautions when mounting the sound bar on a wall. The sound bar may fall, resulting in injury.
  - Do not attach it to a wall constructed of weak materials such as drywall or plasterboard.
  - Use screws that are of the size specified in this document and that can support the weight of the installation. Do not use nails, two-sided tape, screws other than the size specified, or screws that are worn out or damaged.
  - Fix the cables in place so nothing will accidentally catch on them.
- Check that the sound bar is securely fixed in place immediately after the installation. Yamaha will bear no responsibility for any accidents caused by improper installations.

## ■ Precautions after installation



### CAUTION

- Do not lean on the wall-mounted sound bar or apply excessive force to its top. Doing so may cause the sound bar to fall.

Items to use for wall mounting installation

# Items to use for wall mounting installation

Make sure that all of the following items are present before installing the sound bar.

## ■ Items included with this product

- Spacers A (×2)



- Spacers B (×2, on 1 sheet)



- Mounting template



## ■ Commercially available items

In addition to the included items, the following commercially available items are required.

- Screws (×2)

Choose wood screws of the following size:

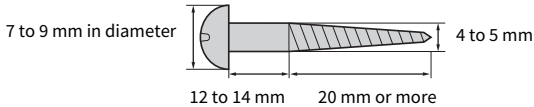

## ■ Tools

Use the following tools for installation.

- Screwdriver  
Use a screwdriver that matches the screws.
- Pencil  
Use to mark the positions for the screws on a wall.
- Tape or thumbtacks  
Use to temporarily attach the mounting template to a wall.

# Mounting the sound bar on a wall

- Before mounting the sound bar on a wall, be sure to read the following precautions.
  - “Precautions” (p.4)

Use the screw-hanging holes on the sound bar to mount the sound bar on a wall.

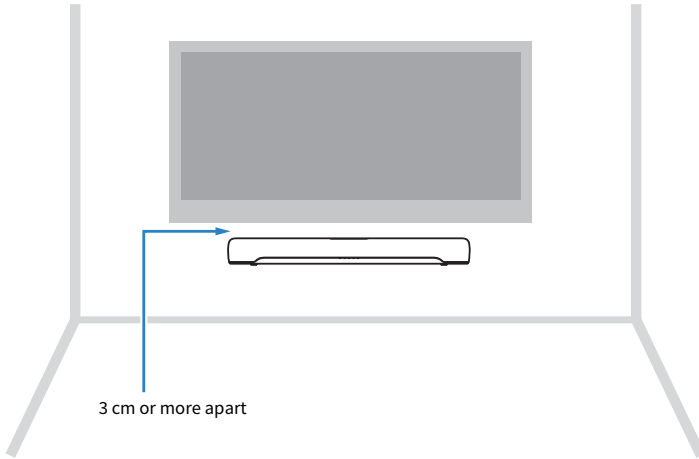

## NOTE

To bring out the best performance of the sound bar, install the sound bar 3 cm or more apart from the TV.

## 1 Attach the mounting template (included) on a wall temporarily.

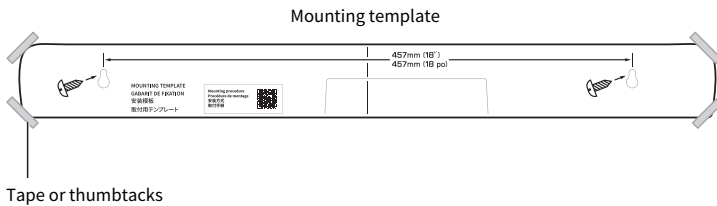

**2 Mark the positions for the screws on the wall using a pencil.**

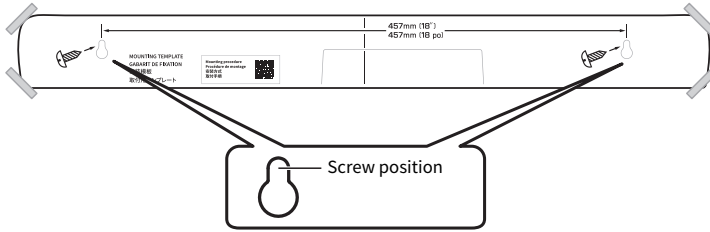

**3 Remove the mounting template from the wall.**

**4 Install the spacers A (included) and screws at the points marked on the wall.**

Be sure to use screws of the following size.

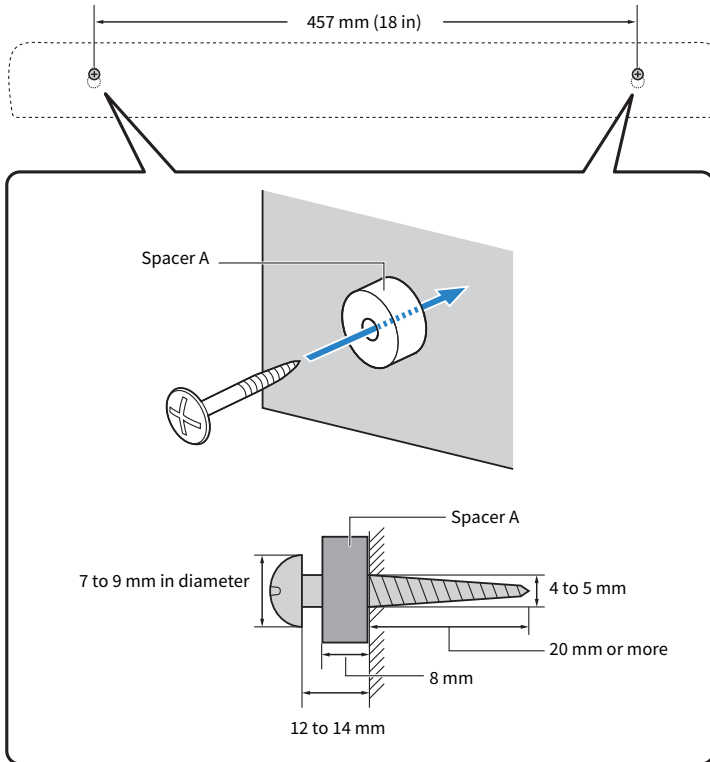

**5 Peel off the backing paper from the spacers B (included), and attach the adhesive face of each spacer to the rear of the sound bar.**

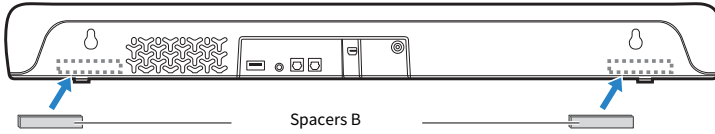

**6 Connect cables to the sound bar.**

For the connection procedure, see the Quick Start Guide or User Guide of your product.

**7 Hang the sound bar on the screws.**

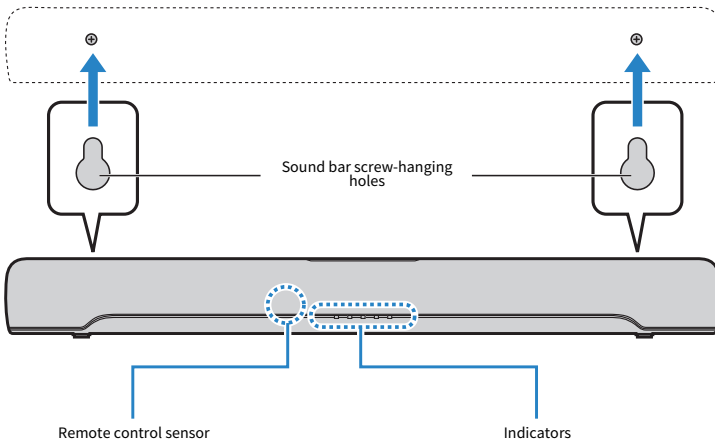

When installation and all connections are complete, while the power is off, hold down BASS EXT on the sound bar's remote control for at least five seconds to optimize the frequency characteristics setting for wall mounting. The indicators show the setting status as follows, and the sound bar is turned on.

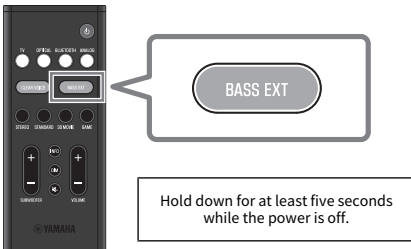

Remote control

## Mounting the sound bar on a wall

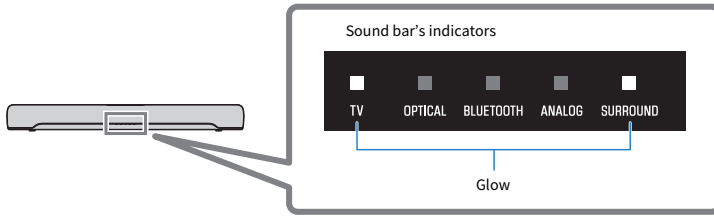

The setting is completed.

### **NOTE**

When changing the installation of the sound bar from wall-mounted to on a stand, also change the frequency characteristics setting. For more information, refer to the User Guide of your product.

Yamaha Global Site  
<https://www.yamaha.com/>

Yamaha Downloads  
<https://download.yamaha.com/>

© 2022 Yamaha Corporation

Published 05/2022 NV-A0

AV21-0136



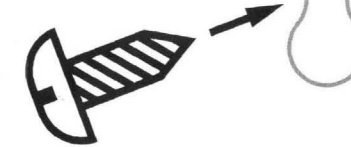

MOUNTING TEMPLATE  
GABARIT DE FIXATION  
安装模板  
取付用プレート

Mounting procedure  
Procédure de montage  
安装方式  
取付手順



457mm (18")  
457mm (18 po)





**Sound Bar  
Barre de son  
Barra de Sonido**

**SR-C30A  
ATS-C300**

**Safety Brochure**

---

**EN**

**Brochure sur la Sécurité**

---

**FR**

**Folleto de seguridad**

---

**ES**

**IMPORTANT**

Please record the serial number of this unit in the space below.

**Model**

---

**Serial No.**

---

The serial number is located on the bottom or rear of the unit. Retain this Owner's Manual in a safe place for future reference.

(1024 Ser.No)

- This applies only to products distributed by YAMAHA CANADA MUSIC

**CAN ICES-3 (B)/NMB-3(B)**

(can\_b\_02)

# FCC INFORMATION (U.S.A.)

## 1. **IMPORTANT NOTICE: DO NOT MODIFY THIS UNIT!**

This product, when installed as indicated in the instructions contained in this manual, meets FCC requirements. Modifications not expressly approved by Yamaha may void your authority, granted by the FCC, to use the product.

## 2. **IMPORTANT:** When connecting this product to accessories and/ or another product use only high quality shielded cables. Cable/s supplied with this product **MUST** be used. Follow all installation instructions. Failure to follow instructions could void your FCC authorization to use this product in the USA.

## 3. **NOTE:** This product has been tested and found to comply with the requirements listed in FCC Regulations, Part 15 for Class "B" digital devices. Compliance with these requirements provides a reasonable level of assurance that your use of this product in a residential environment will not result in harmful interference with other electronic devices. This equipment generates/uses radio frequencies and, if not installed and used according to the instructions found in the users manual, may cause interference harmful to the operation of other electronic devices. Compliance with FCC regulations does not guarantee that interference will not occur in all installations. If this product is found to be the source of interference, which can be determined by turning the unit "OFF" and "ON", please try to eliminate the problem by using one of the following measures:

- Relocate either this product or the device that is being affected by the interference.
- Utilize power outlets that are on different branch (circuit breaker or fuse) circuits or install AC line filter/s.
- In the case of radio or TV interference, relocate/reorient the antenna. If the antenna lead-in is 300 ohm ribbon lead, change the lead-in to co-axial type cable.

If these corrective measures do not produce satisfactory results, please contact the local retailer authorized to distribute this type of product. If you can not locate the appropriate retailer, please contact Yamaha Corporation of America, 6600 Orangethorpe Ave., Buena Park CA90620 The above statements apply **ONLY** to those products distributed by Yamaha Corporation of America or its subsidiaries.

(0529-M02 FCC class B)

# COMPLIANCE INFORMATION STATEMENT (Supplier's declaration of conformity procedure)

Responsible Party : Yamaha Corporation of America  
Address : 6600 Orangethorpe Avenue, Buena Park, CA 90620  
Telephone : 714-522-9011  
Type of Equipment : Sound Bar  
Model Name : SR-C30A, ATS-C300

This device complies with Part 15 of FCC Rules. Operation is subject to the following two conditions: (1) this device may not cause harmful interference, and (2) this device must accept any interference received, including interference that may cause undesired operation.

(0529-M06 FCC sDoc)

## **NOTICE (For U.S.A.)**

- This equipment complies with FCC radiation exposure limits set forth for an uncontrolled environment and meets the FCC radio frequency (RF) Exposure Guidelines. This equipment should be installed and operated keeping the radiator at least 20 cm or more away from person's body.
- This transmitter must not be co-located or operated in conjunction with any other antenna or transmitter.

## **NOTICE (For Canada)**

- This equipment complies with ISED radiation exposure limits set forth for an uncontrolled environment and meets RSS-102 of the ISED radio frequency (RF) Exposure rules. This equipment should be installed and operated keeping the radiator at least 20 cm or more away from person's body.
- This device contains licence-exempt transmitter(s)/receiver(s) that comply with Innovation, Science and Economic Development Canada's licence-exempt RSS(s). Operation is subject to the following two conditions:
  - 1. This device may not cause interference.
  - 2. This device must accept any interference, including interference that may cause undesired operation of the device.

# PRECAUTIONS

## PLEASE READ CAREFULLY BEFORE USE. BE SURE TO FOLLOW THESE INSTRUCTIONS.

The precautions listed below are to prevent risk of harm to the user and others, as well as to prevent property damage, and to help the user use this unit properly and safely. Be sure to follow these instructions.

After reading this manual, be sure to keep it in a safe place where it can be referenced at any time.

- Be sure to request inspections or repairs from the dealer where you purchased the unit or from qualified Yamaha service personnel.
- Yamaha cannot be held responsible for injury to you or damage of the products caused by improper use or modifications to the unit, or data that is lost or destroyed.
- This product is for ordinary homes. Do not use for applications requiring high reliability, such as managing lives, health care or high-value assets.



### **WARNING**

This content indicates “risk of serious injury or death.”

### **If you notice any abnormality**

- If any of the following abnormalities occur, immediately turn off the power and disconnect the power plug.
  - The power cord/plug is damaged.
  - An unusual smell, unusual sound or smoke is emitted from the unit.
  - Foreign material or water gets into the interior of the unit.

- There is a loss of sound during use.
- There is a crack or damage in the unit.

Continued use could cause electric shocks, a fire, or malfunctions. Immediately request an inspection or repair from the dealer where you purchased the unit from qualified Yamaha service personnel.

### **Power supply**

- Do not do anything that could damage the power cord.
  - Do not place it near a heater.
  - Do not bend it excessively or alter it.
  - Do not scratch it.
  - Do not place it under a heavy object.Using the power cord with the core of the cord exposed could cause electric shocks or a fire.
- Do not touch the power plug or cord if there is a chance of lightning. Failure to observe this may cause electric shocks.
- Use this unit with the power supply voltage printed on it. Failure to connect to an appropriate AC outlet may cause a fire, electric shocks, or malfunctions.
- Be sure to use the supplied AC adaptor and power cord. Failure to observe the above may cause a fire, burns, or malfunctions.
- Do not use the supplied AC adaptor and power cord for other units. Failure to observe the above may cause a fire, burns, or malfunctions.
- Check the electric plug periodically and remove any dirt or dust which may have accumulated on it. Failure to observe this may cause a fire or electric shocks.
- When setting up the unit, make sure that the AC outlet you are using is easily accessible. If some trouble or malfunction occurs, immediately turn off the power switch and disconnect the plug from the AC outlet. Even when the power switch is turned off, as long as the power cord is not unplugged from the wall AC outlet, the unit will not be disconnected from the power source.
- If not using the unit for long periods of time, be sure to pull the power plug from the AC outlet. Failure to observe this may cause a fire or malfunctions.

## Installation

---

- Install in the manner instructed in the manual.  
Falling or toppling may result in injury or damage.

## Do not disassemble

---

- Do not disassemble or modify this unit.  
Failure to observe this may cause a fire, electric shocks, injury, or malfunctions.

## Water warning

---

- Do not expose the unit to rain, use it near water or in damp or wet conditions, or place on it any containers (such as vases, bottles or glasses) containing liquids which might spill into any openings or places where water may drop. A liquid such as water getting into the unit may cause a fire, electric shocks, or malfunctions.
- Never insert or remove an electric plug with wet hands. Do not handle this unit with wet hands.  
Failure to observe this may cause electric shocks or malfunctions.

## Fire warning

---

- Do not place any burning items or open flames near the unit, since they may cause a fire.

## Handling caution

---

- Be careful not to drop or apply strong impact to this unit.  
Failure to observe this may cause electric shocks, a fire, or malfunctions.

## Battery for the remote control

---



- **DO NOT INGEST BATTERY, CHEMICAL BURN HAZARD**  
The remote control supplied with this product contains a coin/button cell battery. If the coin/button cell battery is swallowed, it can cause severe internal burns in just 2 hours and can lead to death.  
Keep new and used batteries away from children. If the battery compartment does not close securely, stop using the product and keep it away from children.  
If you think batteries might have been swallowed or placed inside any part of the body, seek immediate medical attention.

- Do not disassemble a battery.  
If the contents of the battery get on your hands or in your eyes, it can cause blindness or chemical burns.
- Do not dispose of a battery in fire.
- Do not expose the battery to conditions of extreme low air pressure, cold or heat (such as in direct sunlight or a fire) or excessive dust or humidity.  
Doing so may result in the battery bursting, causing a fire or injury.
- Do not attempt to recharge batteries that are not intended to be charged.  
Charging could cause the battery to burst or leak, which can cause blindness, chemical burns, or injury.
- If the batteries do leak, avoid contact with the leaked fluid.  
If the battery fluid should come in contact with your eyes, mouth, or skin, wash immediately with water and consult a doctor. Battery fluid is corrosive and may possibly cause loss of sight or chemical burns.

## Wireless unit

---

- Do not use this unit near medical devices or inside medical facilities.  
Radio waves from this unit may affect electro-medical devices.
- Do not use this unit within 15 cm (6 in) of persons with a heart pacemaker implant or a defibrillator implant.  
Radio waves from this unit may affect electro-medical devices, such as a heart pacemaker implant or defibrillator implant.



## CAUTION

This content indicates “risk of injury.”

### Power supply

---

- Do not cover or wrap the AC adaptor with a cloth or blanket. Failure to observe this may trap heat, causing deformation in the case or a fire.
- Do not use an AC outlet where the power plug fits loosely when inserted. Failure to observe this may cause a fire, electric shocks, or burns.
- When disconnecting the power plug, always hold the plug itself and not the cord. Pulling by the cord can damage it and cause electric shocks or a fire.
- Insert the power plug firmly all the way into the AC outlet. Using the unit when it is not plugged in sufficiently can cause dust to accumulate on the plug, causing a fire or burns.

### Installation

---

- Do not place the unit in an unstable position where it might accidentally drop or fall over and cause injuries.
- When installing this unit, do not obstruct heat dissipation.
  - Do not cover it with any cloth.
  - Do not install it on a carpet or rug.
  - Do not block this unit's ventilation holes (cooling slits). (Refer to Fig. 1 on page 6.)
  - Do not install the unit in other ways than indicated.
  - Do not use the device in a confined, poorly-ventilated location.Failure to observe the above may trap heat inside the unit, causing a fire or malfunctions. Ensure that there is adequate space around the sound bar: at least 10 cm (4 in) on top, 10 cm (4 in) on the sides, and 10 cm (4 in) on the rear. Ensure that there is adequate space around the subwoofer: at least 20 cm (8 in) on top, 20 cm (8 in) on the sides, and 20 cm (8 in) on the rear.
- Do not install the unit in places where it may come into contact with corrosive gases or salt air or places that have excessive smoke or steam. Doing so may result in malfunction.
- Avoid being near the unit during a disaster, such as an earthquake.

Since the unit may turn over or fall and cause injury, quickly move away from the unit and go to a safe place.

- Before moving this unit, be sure to turn off the power switch and disconnect all connection cables. Failure to observe this may damage the cables or cause you or someone else to trip and fall.
- For proper mounting the sound bar on a wall, make sure to have it done by the dealer from where you purchased the unit or by qualified service personnel. Failure to observe this may cause the installation to fall and result in injury. Installation requires special skills and experience.

### Hearing loss

---

- Do not use the unit for a long period of time at a high or uncomfortable volume level, since this can cause permanent hearing loss. If you experience any hearing loss or ringing in the ears, consult a physician.
- Before connecting the unit to other devices, turn off the power for all devices. Failing to do so may result in hearing loss, electric shock, or device damage.

### Maintenance

---

- Remove the power plug from the AC outlet before cleaning the unit. Failure to observe this may cause electric shocks.

### Handling caution

---

- Do not insert your hand or fingers into the bass reflex port of the subwoofer. (Refer to Fig. 2 on page 6.) Failure to observe this may cause injury.
- Do not insert foreign materials such as metal or paper into the ventilation holes (cooling slits) of the sound bar and the bass reflex port of the subwoofer. (Refer to Figs. 1 and 2 on page 6.) Failure to observe this may cause a fire, electric shocks, or malfunctions.
- Keep small parts out of the reach of infants. Your children may accidentally swallow them.
- Do not do the following:
  - stand on or sit on the equipment.
  - put heavy items on top of the equipment.

- place the equipment in a stack.
  - apply unreasonable force to buttons, switches, input/output terminals, etc.
  - hang on the sound bar installed on a wall.
  - lean against the sound bar installed on a wall.
- Failure to observe this may cause injuries or damage to the equipment.
- Avoid pulling the connected cables to prevent injuries or damage to the unit by causing it to fall.

## Battery for the remote control

- Do not use batteries other than specified batteries.  
Doing so may cause fire or burns, or result in fluid leakage that may cause skin inflammation.
- Do not put in a pocket or bag, carry, or store batteries together with pieces of metal.  
The battery could short, burst, or leak, causing a fire or injury.
- Always make sure all batteries are inserted in conformity with the +/- polarity markings.  
Failure to do so might result in a fire, burns, or inflammation due to fluid leaks.
- When the batteries run out, or if the unit is not to be used for a long time, remove the batteries from the remote control to prevent possible leakage of the battery fluid.
- When storing or discarding batteries, insulate the terminal area by applying tape, or some other protection.  
Mixing them with other batteries or metal objects can cause a fire, burns, or inflammation due to fluid.

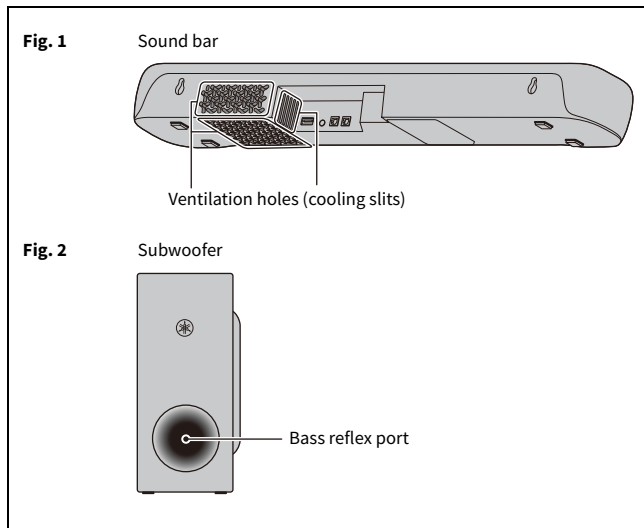

## Notice

Indicates points that you must observe in order to prevent product failure, damage or malfunction and data loss.

### Power supply

- If not using the unit for a long period of time, be sure to pull the power plug from the outlet. Even if this unit is turned off by [⏻](Standby/On), a minute current is still flowing.



## Installation

---

- Do not use this unit in a location that is exposed to direct sunlight that becomes extremely hot, such as near a heater, or extremely cold, or that is subject to excessive dust or vibration. Failure to observe this may cause the unit's panel to become deformed, the internal components to malfunction, or for operation to become unstable.
- If using a wireless function, avoid installing this unit near metal walls or desks, microwave ovens, or other wireless network devices. Obstructions could shorten the transmission distance.

## Connections

---

- If connecting external units, be sure to thoroughly read the manual for each unit and connect them in accordance with the instructions. Failure to properly handle a unit in accordance with the instructions could cause malfunctions.
- Do not connect this unit to industrial units. This unit has been designed to connect to a consumer-use unit. Connection to an industrial unit could cause this unit to malfunction.

## Handling

---

- Do not place vinyl, plastic, or rubber products on this unit. Failure to observe this may cause discoloration or deformation in the panel of this unit.
- If the ambient temperature changes drastically (such as during unit transportation or under rapid heating or cooling) and there is a chance condensation may have formed in the unit, leave the unit for several hours without turning on the power until it is completely dry before use. Using the unit while there is condensation can cause malfunctions.

## Maintenance

---

- When cleaning the unit, use a dry, soft cloth. Using chemicals such as benzine or thinner, cleaning agents, or chemical scrubbing cloths can cause discoloration or deformation.

## Speakers

---

- Do not touch the speaker units. Failure to observe this may damage the speaker units.

## Disposal or transfer

---

- Be sure to discard used batteries in accordance with local regulations.
- If you plan to transfer ownership of this product, include this document and the supplied accessories along with the product.
- Follow the rules of your local authority to dispose of this product and its accessories.

This product contains a battery that contains perchlorate material. Perchlorate Material—special handling may apply, See [www.dtsc.ca.gov/hazardouswaste/perchlorate](http://www.dtsc.ca.gov/hazardouswaste/perchlorate).  
\* This applies only to products distributed by Yamaha Corporation of America.

(0583 Perchlorate)

# Information

## About functions included in the unit

---

- Air may be blown out from the bass reflex port. (Refer to Fig. 2 on page 6.) This is not a malfunction. This occurs particularly often when outputting music with heavy bass.

## About the name plate of the unit

---

- Sound bar

The model number, serial number, power requirements, etc., may be found on or near the name plate, which is at the bottom of the unit. You should note this serial number in the space provided below and retain this manual as a permanent record of your purchase to aid identification in the event of theft.

**Model No.**

---

**Serial No.**

---

(bottom\_en\_02)

YAMAHA CORPORATION

10-1 Nakazawa-cho, Naka-ku, Hamamatsu, 430-8650 Japan

Yamaha Global Site  
<https://www.yamaha.com/>

Yamaha Downloads  
<https://download.yamaha.com/>

© 2022 Yamaha Corporation  
Published 05/2022  
KSOD-A0

VFS3150

UA



# YAMAHA

## LIMITED WARRANTY ON HOME AUDIO PRODUCTS

Thank you for selecting a YAMAHA product. YAMAHA products are designed and manufactured to provide a high level of defect-free performance. Yamaha Corporation of America ("YAMAHA") is proud of the experience and craftsmanship that goes into each and every YAMAHA product. YAMAHA sells its products through a network of reputable, specially authorized dealers and is pleased to offer you, the Original Owner, the following Limited Warranty, which applies only to products that have been (1) directly purchased from YAMAHA's authorized dealers in the USA, including Puerto Rico (the "Warranted Area") and (2) used exclusively in the Warranted Area. YAMAHA suggests that you read the Limited Warranty thoroughly, and invites you to contact your authorized YAMAHA dealer or YAMAHA Customer Service if you have any questions.

### THIS WARRANTY COVERS THE LISTED PRODUCTS AGAINST DEFECTS IN MATERIALS OR WORKMANSHIP FOR THE NUMBER OF YEARS IDENTIFIED BELOW.

<u>Warranty Term</u>	
Type of Product	Duration of Warranty from Date of Purchase by or for the Original Owner
<i>A/V and Stereo Receivers, Processor and Integrated Amplifiers, Separate Amplifiers and Preamplifiers, Tuners, CD Players and Changers, HDD Players and Recorders, Network Players, Powered Loudspeakers, Media Controllers and Speaker Systems purchased individually, as a pair, or as part of an Integrated or Packaged System.</i>	..... 2 years
<i>Cassette Decks, Blu-ray Disc Players, DVD Players and Changers, Integrated Systems (Receiver or Amplifier combined or on same chassis with CD, DVD or Blu-ray Disc Player), Desktop Audio Systems (i.e. TSX and PDX Series), Multimedia Speakers, Headphones, Earphones and Accessories.</i>	..... 1 year

**Coverage:** YAMAHA will, at its option, repair or replace the product covered by this warranty if it becomes defective, malfunctions or otherwise fails to conform with this warranty under normal use and service during the term of this warranty, without charge for labor or materials. Repairs may be performed using new or refurbished parts that meet or exceed YAMAHA specifications for new parts. If YAMAHA elects to replace the product, the replacement may be a reconditioned unit. You will be responsible for any installation or removal charges and for any initial shipping charges if the product(s) must be shipped for warranty service. However, YAMAHA will pay the return shipping charges to any destination within the USA if the repairs are covered by the warranty. This warranty does not cover (a) damage, deterioration or malfunction resulting from accident, negligence, misuse, abuse, improper installation or operation or failure to follow instructions according to the Owner's Manual for this product; any shipment of the product (claims must be presented to the carrier); repair or attempted repair by anyone other than YAMAHA or an authorized YAMAHA Service Center; (b) any unit which has been altered or on which the serial number has been defaced, modified or removed; (c) normal wear, battery or battery replacement and any periodic maintenance; (d) deterioration due to perspiration, corrosive atmosphere or other external causes such as extremes in temperature or humidity; (e) damages attributable to power line surge or related electrical abnormalities, lightning damage or acts of God; (f) RFI/EMI (Interference/noise) caused by improper grounding or the improper use of either certified or uncertified equipment, if applicable; or (g) interference arising from the use of wireless communication devices (e.g. 2.4 GHz cordless telephones), or other radio frequency emitting products such as microwave ovens, whether such interference impairs the operation of the product or vice-versa. Consult the Owner's Manual for guidance on set-up procedures for minimizing the risks of interference. Any evidence of alteration, erasing or forgery of proof-of-purchase documents will cause this warranty to be void. This warranty covers only the Original Owner and is not transferable.

**In Order to Obtain Warranty Service:** Warranty service will only be provided for defective products within the Warranted Area. Contact your local authorized YAMAHA dealer who will advise you of the procedures to be followed. If this is not successful, contact YAMAHA at the address, telephone number or website shown below. YAMAHA may request that you send the defective product to a local authorized YAMAHA Servicer or authorize return of the defective product to YAMAHA for repair. For products requiring in-home service, contact your local authorized Yamaha dealer to arrange for service. If you are uncertain as to whether a dealer has been authorized by YAMAHA, please contact YAMAHA's Service Department at the number shown below, or check Yamaha's website at <http://usa.yamaha.com>. Product(s) shipped for service should be packed securely and must be accompanied by a detailed explanation of the problem(s) requiring service, together with the original or a machine reproduction of the bill of sale or other dated, proof-of-purchase document describing the product, as evidence of warranty coverage. Should any product submitted for warranty service be found ineligible therefore, an estimate of repair cost will be furnished and the repair will be accomplished only if requested by you and upon receipt of payment or acceptable arrangement for payment.

**Limitation of Implied Warranties and Exclusion of Damages:** ANY IMPLIED WARRANTIES, INCLUDING WARRANTIES OF MERCHANTABILITY AND FITNESS FOR A PARTICULAR PURPOSE SHALL BE LIMITED IN DURATION TO THE APPLICABLE PERIOD OF TIME SET FORTH ABOVE. YAMAHA SHALL NOT BE RESPONSIBLE FOR INCIDENTAL OR CONSEQUENTIAL DAMAGES OR FOR DAMAGES BASED UPON INCONVENIENCE, LOSS OF USE, DAMAGE TO ANY OTHER EQUIPMENT OR OTHER ITEMS AT THE SITE OF USE OR INTERRUPTION OF PERFORMANCES OR ANY CONSEQUENCES. YAMAHA'S LIABILITY FOR ANY DEFECTIVE PRODUCT IS LIMITED TO REPAIR OR REPLACEMENT OF THE PRODUCT, AT YAMAHA'S OPTION. SOME STATES DO NOT ALLOW LIMITATIONS ON HOW LONG AN IMPLIED WARRANTY LASTS OR THE EXCLUSION OR LIMITATION OF INCIDENTAL OR CONSEQUENTIAL DAMAGES, SO THE ABOVE LIMITATION OR EXCLUSION MAY NOT APPLY TO YOU. This Warranty gives you specific legal rights, and you may also have other rights which vary from state to state. This is the only express warranty applicable to the product specified herein; Yamaha neither assumes nor authorizes anyone to assume for it any other express warranty.

If you have any questions about service received or if you need assistance in locating an authorized YAMAHA Servicer, please contact:



# YAMAHA

CUSTOMER SERVICE

Yamaha Corporation of America

6600 Orangethorpe Avenue, Buena Park, California 90620-1373

Telephone: 800-292-2982

<http://usa.yamaha.com>

**Do not return any product to the above address without a written Return Authorization issued by YAMAHA.**



# YAMAHA AUDIO WARRANTY

Yamaha Canada Music Ltd. warrants to the original purchaser of its audio products that such products are free from defects in workmanship and materials as follows:

Product	Warranty Period from date of Original Purchase
* Receivers, Amplifiers, Tuners, Compact Disc Players, Digital Sound Projectors, Speaker Systems and Subwoofers purchased individually .....	2 years
* DVD Players, CD Recorders, Blu-ray Disc Players, Network Music Players and Commanders, Clock Radios, iPod Speaker Systems, Powered Multimedia Speakers, Headphones, Earphones, Integrated Systems (Receiver or Amplifier combined or on same chassis with an Optical Disc Player along with any included Speakers), Accessories.....	1 year
* Lamp Cartridge for Projectors.....	180 days

Subject to the following terms and conditions if any Yamaha Canada Music Ltd. audio products become defective during the applicable warranty period. Yamaha Canada Music Ltd. will repair such product without charge, including both parts and labour.

## Terms and Conditions:

1. Defective units must be returned to an authorized Yamaha Audio Service Centre together with a complete description of the defect, and Bill of Sale.
2. Any transportation, packing and insurance arrangements are the responsibility of the owner.
3. This warranty does not cover normal maintenance of the products and is subject to the products being properly maintained in accordance with the maintenance instructions contained in the Yamaha Owner's Manual.
4. This Warranty does not cover:
  - a) Physical damage due to abuse:
  - b) Shipping damage.
  - c) Burned voice coils on tweeter and midrange speakers (caused by amplifier chipping, i.e. operation of amplifier beyond rated wattage.)
  - d) Burned voice coils on woofers (caused by overpowering the speakers, i.e. operation of amplifier at power levels beyond speaker capability).
  - e) Performance checks.
  - f) Interconnection cables and FM antennas.
  - g) Blown fuses caused by improper operation.
5. This warranty does not cover products which have been altered or repaired other than by an authorized Yamaha Audio Service Centre, or products whose trademark name, model, or serial number have been altered or removed.
6. THIS WARRANTY COVERS ONLY NEW AND UNUSED MERCHANDISE SOLD BY AUTHORIZED YAMAHA AUDIO DEALERS IN CANADA, AND SUBJECT TO NORMAL CONSUMER USE, BY THE ORIGINAL PURCHASER.
7. This warranty does not apply to Yamaha Canada Music Ltd. audio products sold in Saskatchewan, and to which statutory warranties contained in The Consumer Products Warranties Act, 1977 (Saskatchewan) are applicable.
8. This warranty is void where prohibited by law.

## Factory Service Centre located at:

135 Milner Avenue, Scarborough, Ontario, M1S 3R1.  
(416) 298-1311  
[http://ca.yamaha.com/en/support/getting\\_service/](http://ca.yamaha.com/en/support/getting_service/)

For the location of other service centres, contact any Yamaha Audio Dealer or the above.

A WARRANTY REGISTRATION CARD IS NOT REQUIRED.

PLEASE KEEP YOUR BILL OF SALE AS PROOF OF PURCHASE SHOULD WARRANTY REPAIRS BE REQUIRED.



# GARANTIE DES APPAREILS STEREOPHONIQUES YAMAHA

Yamaha Canada Musique Ltée., garantit à l'acheteur original ses appareils stéréophoniques contre toutes déficiences de matériaux et de main-d'œuvre, selon les conditions ci-dessous:

## Appareils

## Durée de validité de la garantie à partir de la date d'achat originale

- \* Récepteurs, amplificateurs, syntoniseurs, lecteurs de disque compact, projecteur de son numérique, ensembles de haut-parleurs et caissons de graves achetés séparément ..... 2 ans
- \* Lecteurs de DVD, enregistreurs de CD, lecteurs de disque Bluray, lecteurs de musique réseau et gestionnaires, radios-réveils, ensembles de haut-parleurs iPod, haut-parleurs multimédias, casques d'écoute, écouteurs, systèmes intégrés (récepteur ou amplificateur combiné à ou sur le même bâti qu'un lecteur de disque optique et haut-parleurs inclus), accessoires ..... 1 an
- \* Cartouche à Lampe pour le Projecteur ..... 180 jours

Sous réserve des conditions stipulées ci-après, Yamaha Canada Musique Ltée., s'engage à réparer gratuitement, incluant les pièces et la main-d'œuvre, ses appareils stéréophoniques devenant défectueux au cours de la durée de la garantie applicable.

## CONDITIONS:

1. Les appareils défectueux doivent être retournés, accompagnés d'une description complète de la déficience et la facture d'achat, à un centre de service Yamaha autorisé.
2. Le transport, l'emballage et l'assurance sont à la charge du propriétaire.
3. La présente garantie ne s'étend pas à l'entretien normal des appareils et est assujettie à leur maintien en bon état, conformément au mode d'entretien reproduit dans le manuel d'instructions.
4. Exclus de la présente garantie:
  - a) les dommages matériels résultant d'un abus d'emploi;
  - b) les avaries survenues en cours d'expédition;
  - c) le grillage des bobines mobiles aux haut-parleurs des médiums et des aigus (entraînés par le fonctionnement des amplificateurs au-delà de la puissance nominale);
  - d) le grillage des bobines mobiles aux haut-parleurs des graves (résultant d'une suralimentation des haut-parleurs par leur fonctionnement à des niveaux d'alimentation supérieurs à leur capacité);
  - e) les vérifications de rendement;
  - f) les fils d'interconnexion et les antennes FM;
  - g) les fusibles qui brûlent par suite d'une utilisation incorrecte.
5. Cette garantie ne couvre pas les produits qui ont été altérés ou réparés autre que par un centre de service autorisé Yamaha Audio, ou les appareils dont la marque de fabrique, le nom du fabricant, le numéro de modèle et le numéro de série ont été altérés ou enlevés.
6. LA GARANTIE NE COUVRE QUE LES APPAREILS A L'ETAT NEUF VENDUS PAR DES CONCESSIONNAIRES AUTORISES DE YAMAHA AUDIO AU CANADA, SOUS RESERVE QUE L'ACHETEUR ORIGINAL EN FASSE UNE UTILISATION NORMALE.
7. La garantie ne couvre pas les appareils stéréophoniques de Yamaha Canada Musique Ltée., vendus en Saskatchewan et auxquels s'appliquent les garanties réglementaires prévues par la loi intitulée "The Consumer Products Warranties Act, 1977" (Saskatchewan).
8. Cette garantie ne peut s'exercer dans les territoires où elle est interdite par la loi.

## Adresses des centres de service principaux:

135 Milner Avenue, Scarborough, Ontario, M1S 3R1.  
Tél: (416) 298-1311  
[http://ca.yamaha.com/fr/support/getting\\_service/](http://ca.yamaha.com/fr/support/getting_service/)

Pour connaître l'adresse des autres centres de service Yamaha, renseignez-vous auprès d'un concessionnaire d'appareils stéréophoniques Yamaha ou communiquez avec l'un des centres ci-dessus.

LA CARTE DE GARANTIE N'EST PAS REQUISE.

PRIERE DE CONSERVER VOTRE FACTURE COMME PREUVE D'ACHAT EN CAS DE TOUTES REPARATIONS EFFECTUEES SOUS LA GARANTIE.



010394

ZY48690  
VQE1A1091Z



## Product Registration

Thank you for purchasing a Yamaha product.  
To help us provide better services to our customers via the Internet, we encourage you to complete product registration.

<http://4wrd.it/MEMBER>

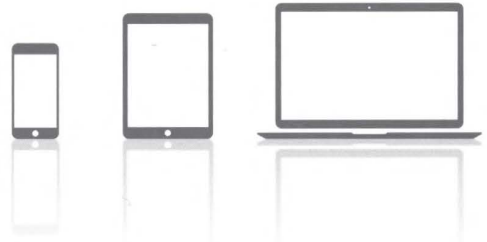

## Enregistrement du Produit

Merci d'avoir acheté un produit Yamaha.  
Pour nous aider à fournir un meilleur service à nos clients via Internet, nous vous encourageons à compléter l'enregistrement du produit

<http://4wrd.it/MEMBER>



## Produktregistrierung

Vielen Dank, dass Sie sich für ein Yamaha Produkt entschieden haben.  
Damit wir unseren Kunden den bestmöglichen Service auch über das Internet anbieten können, empfehlen wir Ihnen, eine Produktregistrierung abzuschließen.

<http://4wrd.it/MEMBER>



## Registrazione Prodotto

Grazie per avere comprato un prodotto Yamaha.  
Al fine di migliorare i nostri servizi online, vi preghiamo completare la registrazione del Suo prodotto.

<http://4wrd.it/MEMBER>



## 产品注册

谢谢您购买雅马哈产品。  
您完成产品注册后，能够得到我们提供的更完备的在线服务。

<http://4wrd.it/MEMBER>



## Регистрация продукта

Благодарим вас за покупку продукта Yamaha.  
Чтобы помочь нам предоставлять лучшие услуги нашим клиентам через Интернет, мы рекомендуем вам пройти регистрацию продукта.

<http://4wrd.it/MEMBER>



## 제품 등록

야마하 제품을 구매해 주셔서 감사합니다.  
인터넷을 통해 고객에게 더 나은 서비스를 제공할 수 있도록 제품 등록을 완료하시기 바랍니다.

<http://4wrd.it/MEMBER>





# Worldwide Representative Offices

VFE6330

For details of products, please contact your nearest Yamaha representative or the authorized distributor listed below.  
Pour plus de détails sur les produits, contactez votre représentant Yamaha le plus proche de chez vous ou le distributeur agréé indiqué ci-dessous.

Visit the following website for the latest information.  
Visitez le site Web suivant pour les toutes dernières informations.



<https://manual.yamaha.com/av/support/avsalesrep.html>

## NORTH AMERICA

### CANADA

**Yamaha Canada Music Ltd.**  
135 Milner Avenue, Tronto, Ontario M1S 3R1,  
Canada

### U.S.A.

**Yamaha Corporation of America**  
6600 Orangethorpe Avenue, Buena Park,  
CA 90620, USA

## CENTRAL & SOUTH AMERICA

### MEXICO

**Yamaha de México, S.A. de C.V.**  
Av. Insurgentes Sur 1647 Piso 9, Col. San José  
Insurgentes, Delegación Benito Juárez, CDMX,  
C.P. 03900, México

### BRAZIL

**Yamaha Musical do Brasil Ltda.**  
Praça Professor José Lannes, 40, Cjs 21 e 22,  
Brooklin Paulista Novo CEP 04571-100  
– São Paulo – SP, Brazil

### ARGENTINA

**Yamaha Music Latin America, S.A.**  
**Sucursal Argentina**  
Olga Cossettini 1553, Piso 4 Norte  
Madero Este-C1107CEK  
Buenos Aires, Argentina

### PANAMA AND OTHER LATIN AMERICAN COUNTRIES / CARIBBEAN COUNTRIES

**Yamaha Music Latin America, S.A.**  
Edificio Torre Davivienda, Piso: 20  
Avenida Balboa, Marbella, Corregimiento de Bella  
Vista, Ciudad de Panamá, Rep. de Panamá

## EUROPE

### EUROPEAN COUNTRIES

**Yamaha Music Europe GmbH**  
Siemensstrasse 22-34, 25462 Rellingen, Germany

### RUSSIA

**Yamaha Music (Russia) LLC.**  
Room37, entrance 7, bld. 7, Kievskaya street,  
Moscow, 121059, Russia

## AFRICA

### Yamaha Music Gulf FZE

JAFZA-16, Office 512, P.O.Box 17328, Jabel Ali FZE,  
Dubai, U.A.E



### Head Office: Yamaha Corporation

10-1, Nakazawa-cho, Naka-ku, Hamamatsu, 430-8650, Japan

**Importer (European Union): Yamaha Music Europe GmbH**

Siemensstrasse 22-34, 25462 Rellingen, Germany

**Importer (United Kingdom): Yamaha Music Europe GmbH (UK)**

Sherbourne Drive, Tilbrook, Milton Keynes, MK7 8BL, United Kingdom

Manual Development Group

© 2014 Yamaha Corporation

Published 03/2021 KS-10



## MIDDLE EAST

### TURKEY

**Yamaha Music Europe GmbH**  
**Merkezi Almanya Türkiye Istanbul Subesi**  
Mor Sumbul Sokak Varyap Meridian Business  
1.Blok No:1 113-114-115  
Bati Atasehir Istanbul, Turkey

### OTHER REGIONS

**Yamaha Music Gulf FZE**  
JAFZA-16, Office 512, P.O.Box 17328, Jabel Ali FZE,  
Dubai, U.A.E

## ASIA

### THE PEOPLE'S REPUBLIC OF CHINA

**Yamaha Music & Electronics (China) Co., Ltd.**  
2F, Yunhedasha, 1818 Xinzha-lu, Jingan-qu,  
Shanghai, China

### INDIA

**Yamaha Music India Private Limited**  
P-401, JMD Megapolis, Sector-48, Sohna Road,  
Gurgaon-122018, Haryana, India

### INDONESIA

**PT Yamaha Musik Indonesia Distributor**  
**PT. Nusantik**  
Yamaha Music Center Bldg., Jalan Jend. Gatot  
Subroto Kav. 4, Jakarta 12930, Indonesia

### REPUBLIC OF KOREA

**Yamaha Music Korea Ltd.**  
11F, Prudential Tower, 298, Gangnam-daero,  
Gangnam-gu, Seoul, 06253, Korea

### MALAYSIA

**Yamaha Music (Malaysia) Sdn., Bhd.**  
No.8, Jalan Perbandaran, 47301 Kelana Jaya,  
Petaling Jaya, Selangor, Malaysia

## SINGAPORE

**Yamaha Music (Asia) PRIVATE LIMITED**  
Block 202 Hougang Street 21, #02-00,  
Singapore 530202, Singapore

## TAIWAN

**Yamaha Music & Electronics Taiwan Co., Ltd.**  
2F., No.1, Yuandong Rd. Banqiao Dist.  
New Taipei City 22063 Taiwan (R.O.C.)

## THAILAND

**Siam Music Yamaha Co., Ltd.**  
3, 4, 15, 16th Fl., Siam Motors Bldg.,  
891/1 Rama 1 Road, Wangmai, Pathumwan,  
Bangkok 10330, Thailand

## VIETNAM

**Yamaha Music Vietnam Company Limited**  
15th Floor, Nam A Bank Tower  
201-203 Cach Mang Thang Tam St., Ward 4, Dist.3,  
Ho Chi Minh City, Vietnam

## OTHER REGIONS

**Yamaha Corporation**  
Nakazawa-cho 10-1, Naka-ku, Hamamatsu,  
Japan 430-8650

## OCEANIA

### AUSTRALIA / NEW ZEALAND

**Yamaha Music Australia Pty. Ltd.**  
Level 1, 80 Market Street, South Melbourne,  
VIC 3205 Australia